



**LIFETIME  
WARRANTY**

Backed by a Lifetime Warranty, Sunex Impact Sockets are warranted against defects in materials and workmanship for the life of the product. This warranty does not apply to items that have been misused, abused, altered in any way, or worn out from use. Some Adapters, Reducers, and Extra Thin Wall Impact Sockets are sold with out of box warranty.

# IMPACT SOCKETS

Since 1984, we've led the market with our solution-based designs and quality materials. All of our Impact Sockets (low-profile, standard, deep, hex drivers, universal joint, specialty, and extensions/adapters) are backed by an industry-leading warranty, so you can rest easy knowing your sockets are guaranteed to perform.



1/4" Drive.....	Pg 10
3/8" Drive.....	Pg 18
1/2" Drive.....	Pg 43
3/4" Drive.....	Pg 77
1" Drive.....	Pg 88
# 5 Spline.....	Pg 95
Specialty.....	Pg 96

# IMPACT SOCKETS

## HIGHEST QUALITY. HIGHEST STANDARDS.

### RADIUSED CORNERS

Focuses impact on fastener's flat surfaces, increasing torque and reducing wear and rounding to the fastener.

### DURABLE CR-MO STEEL

Precision manufactured with chrome-molybdenum steel for high-impact applications.

### HEAT TREATED / TEMPERED

Sockets are first heat treated to increase hardness and then tempered to maximize durability.



### SPECIALTY SOCKETS

Every job has its own challenges. We offer a wide selection of specialty sockets to handle anything the job calls for.

### METRIC

### SAE

1/4"  
DRIVE

3/8"  
DRIVE

1/2"  
DRIVE

3/4"  
DRIVE

1"  
DRIVE

### NO-SKIP SIZE SPECTRUM

Sunex Impact Socket Sets include every size in the specification range: Largest to smallest, and everything in between.



### GOT YOUR BACK

We warranty our sockets for the lifetime of the product against defects. Some Adapters, Reducers, and Extra Thin Wall Impact Sockets are sold with out of box warranty.



### HEAVY-DUTY STORAGE

Stay organized with a heavy-duty, blow molded storage case, included with most kits.

1/4" DR.



## 1/4" DRIVE SAE & METRIC MASTER IMPACT SOCKET SET

1874 SET OF 74

MODEL	SIZE	MODEL	SIZE
806	3/16"	809D	9/32" (DEEP)
807	7/32"	810D	5/16" (DEEP)
808	1/4"	811D	11/32" (DEEP)
809	9/32"	812D	3/8" (DEEP)
810	5/16"	814D	7/16" (DEEP)
811	11/32"	816D	1/2" (DEEP)
812	3/8"	818D	9/16" (DEEP)
814	7/16"	808U	1/4" (UNIV)
816	1/2"	810U	5/16" (UNIV)
818	9/16"	812U	3/8" (UNIV)
806D	3/16" (DEEP)	814U	7/16" (UNIV)
807D	7/32" (DEEP)	816U	1/2" (UNIV)
808D	1/4" (DEEP)	818U	9/16" (UNIV)

MODEL	SIZE	MODEL	SIZE
804M	4mm	810MD	10mm (DEEP)
8045M	4.5mm	811MD	11mm (DEEP)
805M	5mm	812MD	12mm (DEEP)
8055M	5.5mm	813MD	13mm (DEEP)
806M	6mm	814MD	14mm (DEEP)
807M	7mm	815MD	15mm (DEEP)
808M	8mm	805UM	5mm (UNIV)
809M	9mm	8055UM	5.5mm (UNIV)
810M	10mm	806UM	6mm (UNIV)
811M	11mm	807UM	7mm (UNIV)
812M	12mm	808UM	8mm (UNIV)
813M	13mm	809UM	9mm (UNIV)
814M	14mm	810UM	10mm (UNIV)
815M	15mm	811UM	11mm (UNIV)
8055MD	5.5mm (DEEP)	812UM	12mm (UNIV)
806MD	6mm (DEEP)	813UM	13mm (UNIV)
807MD	7mm (DEEP)	814UM	14mm (UNIV)
808MD	8mm (DEEP)	815UM	15mm (UNIV)
809MD	9mm (DEEP)		

### INVERTED STAR IMPACT SOCKETS

MODEL	SIZE	MODEL	SIZE
1820S1	T10	1820S4	T25
1820S2	T15	1820S5	T27
1820S3	T20	1820S6	T30

Includes: 2" Extension (1802), 4" Extension (1804), 6" Extension (1806), Universal Joint (1800), 3/8" Adapter (3301)

## 1/4" DRIVE SAE & METRIC MASTER IMPACT SOCKET SET

1848 SET OF 48

MODEL	SIZE	MODEL	SIZE
806	3/16"	806D	3/16" (DEEP)
807	7/32"	807D	7/32" (DEEP)
808	1/4"	808D	1/4" (DEEP)
809	9/32"	809D	9/32" (DEEP)
810	5/16"	810D	5/16" (DEEP)
811	11/32"	811D	11/32" (DEEP)
812	3/8"	812D	3/8" (DEEP)
814	7/16"	814D	7/16" (DEEP)
816	1/2"	816D	1/2" (DEEP)
818	9/16"	818D	9/16" (DEEP)

MODEL	SIZE	MODEL	SIZE
804M	4mm	804MD	4mm (DEEP)
8045M	4.5mm	8045MD	4.5mm (DEEP)
805M	5mm	805MD	5mm (DEEP)
8055M	5.5mm	8055MD	5.5mm (DEEP)
806M	6mm	806MD	6mm (DEEP)
807M	7mm	807MD	7mm (DEEP)
808M	8mm	808MD	8mm (DEEP)
809M	9mm	809MD	9mm (DEEP)
810M	10mm	810MD	10mm (DEEP)
811M	11mm	811MD	11mm (DEEP)
812M	12mm	812MD <td 12mm (DEEP)	
813M	13mm	813MD	13mm (DEEP)
814M	14mm	814MD	14mm (DEEP)
815M	15mm	815MD	15mm (DEEP)



1/4" DR.

## 1/4" DRIVE SAE IMPACT SOCKET SET

1810 SET OF 10

MODEL	SIZE	MODEL	SIZE
806	3/16"	811	11/32"
807	7/32"	812	3/8"
808	1/4"	814	7/16"
809	9/32"	816	1/2"
810	5/16"	818	9/16"



1/4" DR.

1/4  
DRIVE

## 1/4" DRIVE SAE DEEP IMPACT SOCKET SET

1811 SET OF 10

MODEL	SIZE	MODEL	SIZE
806D	3/16"	811D	11/32"
807D	7/32"	812D	3/8"
808D	1/4"	814D	7/16"
809D	9/32"	816D	1/2"
810D	5/16"	818D	9/16"

1/4"  
DRIVE

## 1/4" DRIVE METRIC IMPACT SOCKET SET

1809 SET OF 9

MODEL	SIZE	MODEL	SIZE
8055M	5.5mm	810M	10mm
806M	6mm	811M	11mm
807M	7mm	812M	12mm
808M	8mm	813M	13mm
809M	9mm		

1/4"  
DRIVE

## 1/4" DRIVE METRIC DEEP IMPACT SOCKET SET

1812 SET OF 9

MODEL	SIZE	MODEL	SIZE
8055MD	5.5mm	810MD	10mm
806MD	6mm	811MD	11mm
807MD	7mm	812MD	12mm
808MD	8mm	813MD	13mm
809MD	9mm		

1/4" DR.

## 1/4" DRIVE SAE & METRIC MASTER MAGNETIC SOCKET SET

- Sockets include a spring loaded magnet that retracts into the socket for extended bolt applications

1818 SET OF 23

MODEL	SIZE	MODEL	SIZE
806MG	3/16"	811MG	11/32"
807MG	7/32"	812MG	3/8"
808MG	1/4"	814MG	7/16"
809MG	9/32"	816MG	1/2"
810MG	5/16"		

MODEL	SIZE	MODEL	SIZE
805MMG	5mm	810MMG	10mm
8055MMG	5.5mm	811MMG	11mm
806MMG	6mm	812MMG	12mm
807MMG	7mm	813MMG	13mm
808MMG	8mm	814MMG	14mm
809MMG	9mm	815MMG	15mm

Includes: Universal Joint (1800), 2" Extension (1802)



## 1/4" DRIVE SAE MAGNETIC IMPACT SOCKET SET

- Sockets include a spring loaded magnet that retracts into the socket for extended bolt applications

1820 SET OF 9

MODEL	SIZE	MODEL	SIZE
806MG	3/16"	811MG	11/32"
807MG	7/32"	812MG	3/8"
808MG	1/4"	814MG	7/16"
809MG	9/32"	816MG	1/2"
810MG	5/16"	818MG	9/16"



## 1/4" DRIVE SAE DEEP MAGNET IMPACT SOCKET SET

- Sockets include a spring loaded magnet that retracts into the socket for extended bolt applications

1830 SET OF 10

MODEL	SIZE	MODEL	SIZE
806DMG	3/6"	811DMG	11/32"
807DMG	7/32"	812DMG	3/8"
808DMG	1/4"	814DMG	7/16"
809DMG	9/32"	816DMG	1/2"
810DMG	5/16"	818DMG	9/16"



1/4" DR.

1/4"  
DRIVE

## 1/4" DRIVE METRIC MAGNETIC IMPACT SOCKET SET

- Sockets include a spring loaded magnet that retracts into the socket for extended bolt applications

1822 SET OF 12

MODEL	SIZE	MODEL	SIZE
805MMG	5mm	810MMG	10mm
8055MMG	5.5mm	811MMG	11mm
806MMG	6mm	812MMG	12mm
807MMG	7mm	813MMG	13mm
808MMG	8mm	814MMG	14mm
809MMG	9mm	815MMG	15mm

1/4"  
DRIVE

## 1/4" DRIVE METRIC DEEP MAGNET IMPACT SOCKET SET

- Sockets include a spring loaded magnet that retracts into the socket for extended bolt applications

1831 SET OF 14

MODEL	SIZE	MODEL	SIZE
804MDMG	4mm	809MDMG	9mm
8045MDMG	4.5mm	810MDMG	10mm
805MDMG	5mm	811MDMG	11mm
8055MDMG	5.5mm	812MDMG	12mm
806MDMG	6mm	813MDMG	13mm
807MDMG	7mm	814MDMG	14mm
808MDMG	8mm	815MDMG	15mm

1/4"  
DRIVE

## 1/4" DRIVE SAE UNIVERSAL IMPACT SOCKET SET

1813 SET OF 6

MODEL	SIZE	MODEL	SIZE
808U	1/4"	814U	7/16"
810U	5/16"	816U	1/2"
812U	3/8"	818U	9/16"

## 1/4" DRIVE METRIC UNIVERSAL IMPACT SOCKET SET

1814 SET OF 12

MODEL	SIZE	MODEL	SIZE
805UM	5mm	810UM	10mm
8055UM	5.5mm	811UM	11mm
806UM	6mm	812UM	12mm
807UM	7mm	813UM	13mm
808UM	8mm	814UM	14mm
809UM	9mm	815UM	15mm



1/4" DR.

## 1/4" DRIVE 12 POINT METRIC MAGNETIC UNIVERSAL IMPACT SOCKET SET

- Sockets include a spring loaded magnet that retracts into the socket for extended bolt applications

1825 SET OF 11

MODEL	SIZE	MODEL	SIZE
805ZUMMG	5mm	811ZUMMG	11mm
806ZUMMG	6mm	812ZUMMG	12mm
807ZUMMG	7mm	813ZUMMG	13mm
808ZUMMG	8mm	814ZUMMG	14mm
809ZUMMG	9mm	815ZUMMG	15mm
810ZUMMG	10mm		



1/4" DR.

1/4"  
DRIVE

## 1/4" DRIVE 8/10mm SEMI-DEEP FLIP SOCKET LEXUS, MERCEDES BENZ, INFINITY, CHEVY & BUICK

- For removing and installing under belly pans on foreign and domestic vehicles
- For work on 10mm Lexus fasteners
- For work on 8mm fasteners on Infinity and Mercedes vehicles
- For work on Splash shield fasteners of Chevrolet Cruze and Buick Verano

80810

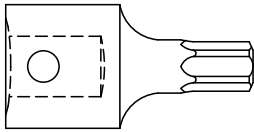
1/4"  
DRIVE

## 1/4" DRIVE INDIVIDUAL STAR SOCKETS

MODEL	SIZE	MODEL	SIZE
1820S1	T10	1820S4	T25
1820S2	T15	1820S5	T27
1820S3	T20	1820S6	T30

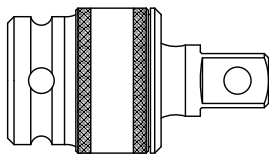
1/4"  
DRIVE

## 1/4" DRIVE INDIVIDUAL UNIVERSAL JOINT

MODEL	SIZE
1800	Universal Joint

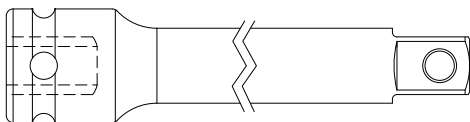
1/4"  
DRIVE

## 1/4" DRIVE INDIVIDUAL EXTENSIONS

MODEL	SIZE
1802	2" Extension
1804	4" Extension
1806	6" Extension

## 1/4" DRIVE INDIVIDUAL SAE SOCKETS

SIZE	STANDARD	DEEP	UNIVERSAL	MAGNETIC	DEEP MAGNETIC
SAE	MODEL	MODEL	MODEL	MODEL	MODEL
3/16"	806	806D	806U	806MG	806DMG
7/32"	807	807D	807U	807MG	807DMG
1/4"	808	808D	808U	808MG	808DMG
9/32"	809	809D	809U	809MG	809DMG
5/16"	810	810D	810U	810MG	810DMG
11/32"	811	811D	811U	811MG	811DMG
3/8"	812	812D	812U	812MG	812DMG
7/16"	814	814D	814U	814MG	814DMG
1/2"	816	816D	816U	816MG	816DMG
9/16"	818	818D	818U	818MG	818DMG

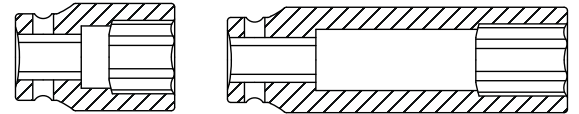

Standard

Deep

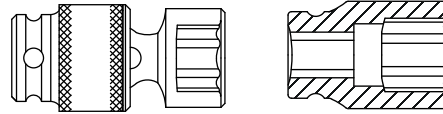

Universal

Magnetic



Deep Magnetic

1/4" DR.

## 1/4" DRIVE INDIVIDUAL METRIC SOCKETS

SIZE	STANDARD	DEEP	UNIVERSAL	MAGNETIC	DEEP MAGNETIC	12 PT. MAG UNIVERSAL
METRIC	MODEL	MODEL	MODEL	MODEL	MODEL	MODEL
4mm	804M	804MD	804UM	804MMG	804MDMG	
4.5mm	8045M	8045MD	8045UM	8045MMG	8045MDMG	
5mm	805M	805MD	805UM	805MMG	805MDMG	805ZUMMG
5.5mm	8055M	8055MD	8055UM	8055MMG	8055MDMG	
6mm	806M	806MD	806UM	806MMG	806MDMG	806ZUMMG
7mm	807M	807MD	807UM	807MMG	807MDMG	807ZUMMG
8mm	808M	808MD	808UM	808MMG	808MDMG	808ZUMMG
9mm	809M	809MD	809UM	809MMG	809MDMG	809ZUMMG
10mm	810M	810MD	810UM	810MMG	810MDMG	810ZUMMG
11mm	811M	811MD	811UM	811MMG	811MDMG	811ZUMMG
12mm	812M	812MD	812UM	812MMG	812MDMG	812ZUMMG
13mm	813M	813MD	813UM	813MMG	813MDMG	813ZUMMG
14mm	814M	814MD	814UM	814MMG	814MDMG	814ZUMMG
15mm	815M	815MD	815UM	815MMG	815MDMG	815ZUMMG

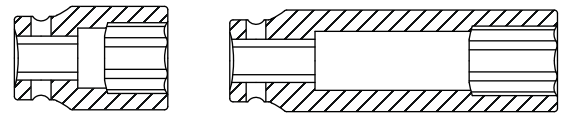

Standard

Deep

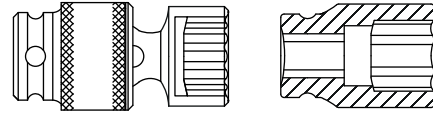

Universal

Magnetic

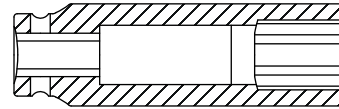

Deep Magnetic

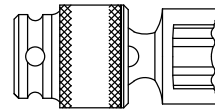

12 pt. Magnetic Universal



## 3/8" DRIVE SAE & METRIC MASTER IMPACT SOCKET SET

3580 SET OF 80

MODEL	SIZE	MODEL	SIZE
310	5/16"	318D	9/16" (DEEP)
312	3/8"	320D	5/8" (DEEP)
314	7/16"	322D	11/16" (UNIV)
316	1/2"	324D	3/4" (UNIV)
318	9/16"	312U	3/8" (UNIV)
320	5/8"	314U	7/16" (UNIV)
322	11/16"	316U	1/2" (UNIV)
324	3/4"	318U	9/16" (UNIV)
310D	5/16" (DEEP)	320U	5/8" (UNIV)
312D	3/8" (DEEP)	322U	11/16" (UNIV)
314D	7/16" (DEEP)	324U	3/4" (UNIV)
316D	1/2" (DEEP)		

MODEL	SIZE	MODEL	SIZE
308M	8mm	313MD	13mm (DEEP)
309M	9mm	314MD	14mm (DEEP)
310M	10mm	315MD	15mm (DEEP)
311M	11mm	316MD	16mm (DEEP)
312M	12mm	317MD	17mm (DEEP)
313M	13mm	318MD	18mm (DEEP)
314M	14mm	319MD	19mm (DEEP)
315M	15mm	310UM	10mm (UNIV)
316M	16mm	311UM	11mm (UNIV)
317M	17mm	312UM	12mm (UNIV)
318M	18mm	313UM	13mm (UNIV)
319M	19mm	314UM	14mm (UNIV)
308MD	8mm (DEEP)	315UM	15mm (UNIV)
309MD	9mm (DEEP)	316UM	16mm (UNIV)
310MD	10mm (DEEP)	317UM	17mm (UNIV)
311MD	11mm (DEEP)	318UM	18mm (UNIV)
312MD	12mm (DEEP)	319UM	19mm (UNIV)

### STAR AND INVERTED STAR IMPACT SOCKETS

MODEL	SIZE	MODEL	SIZE
3670SE1	E5	3670S1	T20
3670SE2	E6	3670S2	T25
3670SE3	E7	3670S3	T27
3670SE4	E8	3670S4	T30
3670SE5	E10	3670S5	T40
3670SE6	E11	3670S6	T45
3670SE7	E12	3670S7	T47
3670SE8	E14	3670S8	T50
3670SE9	E16	3670S9	T55

Includes: 1/2"(F) x 3/8"(M) Adapter (2301), 3" Extension (3503)



## 3/8" DRIVE SAE & METRIC MASTER DEEP IMPACT SOCKET SET

3360DD SET OF 28

MODEL	SIZE	MODEL	SIZE
310D	5/16"	322D	11/16"
312D	3/8"	324D	3/4"
314D	7/16"	326D	13/16"
316D	1/2"	328D	7/8"
318D	9/16"	330D	15/16"
320D	5/8"	332D	1"
MODEL	SIZE	MODEL	SIZE
308MD	8mm	315MD	15mm
309MD	9mm	316MD	16mm
310MD	10mm	317MD	17mm
311MD	11mm	318MD	18mm
312MD	12mm	319MD	19mm
313MD	13mm	321MD	21mm
314MD	14mm	322MD	22mm

Includes: 1/2"(F) x 3/8"(M) Adapter (2301), 3" Extension (3503)



## 3/8" DRIVE SAE & METRIC STANDARD & DEEP LENGTH MASTER IMPACT SOCKET SET

3342 SET OF 42

MODEL	SIZE	MODEL	SIZE
310	5/16"	310D	5/16" (DEEP)
312	3/8"	312D	3/8" (DEEP)
314	7/16"	314D	7/16" (DEEP)
316	1/2"	316D	1/2" (DEEP)
318	9/16"	318D	9/16" (DEEP)
320	5/8"	320D	5/8" (DEEP)
322	11/16"	322D	11/16" (DEEP)
324	3/4"	324D	3/4" (DEEP)
MODEL	SIZE	MODEL	SIZE
308M	8mm	308MD	8mm (DEEP)
309M	9mm	309MD	9mm (DEEP)
310M	10mm	310MD	10mm (DEEP)
311M	11mm	311MD	11mm (DEEP)
312M	12mm	312MD	12mm (DEEP)
313M	13mm	313MD	13mm (DEEP)
314M	14mm	314MD	14mm (DEEP)
315M	15mm	315MD	15mm (DEEP)
316M	16mm	316MD	16mm (DEEP)
317M	17mm	317MD	17mm (DEEP)
318M	18mm	318MD	18mm (DEEP)
319M	19mm	319MD	19mm (DEEP)

Includes: Universal Joint (3301), 3" Extension (3503)

3/8" DR.

3/8" DR.

3/8"  
DRIVE

## 3/8" DRIVE SAE MASTER IMPACT SOCKET SET

3325 SET OF 25

MODEL	SIZE	MODEL	SIZE
310	5/16"	310D	5/16" (DEEP)
312	3/8"	312D	3/8" (DEEP)
314	7/16"	314D	7/16" (DEEP)
316	1/2"	316D	1/2" (DEEP)
318	9/16"	318D	9/16" (DEEP)
320	5/8"	320D	5/8" (DEEP)
322	11/16"	322D	11/16" (DEEP)
324	3/4"	324D	3/4" (DEEP)
326	13/16"	326D	13/16" (DEEP)
328	7/8"	328D	7/8" (DEEP)
330	15/16"	330D	15/16" (DEEP)
332	1"	332D	1" (DEEP)

Includes: Universal Joint (3301)

3/8"  
DRIVE

## 3/8" DRIVE 12 POINT SAE MASTER IMPACT SOCKET SET

3326 SET OF 25

MODEL	SIZE	MODEL	SIZE
310Z	5/16"	36801	5/16" (DEEP)
312Z	3/8"	36802	3/8" (DEEP)
314Z	7/16"	36803	7/16" (DEEP)
316Z	1/2"	36804	1/2" (DEEP)
318Z	9/16"	36805	9/16" (DEEP)
320Z	5/8"	36806	5/8" (DEEP)
322Z	11/16"	36807	11/16" (DEEP)
324Z	3/4"	36808	3/4" (DEEP)
326Z	13/16"	36809	13/16" (DEEP)
328Z	7/8"	368010	7/8" (DEEP)
330Z	15/16"	368011	15/16" (DEEP)
332Z	1"	368012	1" (DEEP)

Includes: 3/8" Dr. Universal Joint (3301)



## 3/8" DRIVE METRIC IMPACT SOCKET SET

3351 SET OF 51

MODEL	SIZE	MODEL	SIZE
307M	7mm	315MD	15mm (DEEP)
308M	8mm	316MD	16mm (DEEP)
309M	9mm	317MD	17mm (DEEP)
310M	10mm	318MD	18mm (DEEP)
311M	11mm	319MD	19mm (DEEP)
312M	12mm	320MD	20mm (DEEP)
313M	13mm	321MD	21mm (DEEP)
314M	14mm	322MD	22mm (DEEP)
315M	15mm	307UM	7mm (UNIV)
316M	16mm	308UM	8mm (UNIV)
317M	17mm	309UM	9mm (UNIV)
318M	18mm	310UM	10mm (UNIV)
319M	19mm	311UM	11mm (UNIV)
320M	20mm	312UM	12mm (UNIV)
321M	21mm	313UM	13mm (UNIV)
322M	22mm	314UM	14mm (UNIV)
307MD	7mm (DEEP)	315UM	15mm (UNIV)
308MD	8mm (DEEP)	316UM	16mm (UNIV)
309MD	9mm (DEEP)	317UM	17mm (UNIV)
310MD	10mm (DEEP)	318UM	18mm (UNIV)
311MD	11mm (DEEP)	319UM	19mm (UNIV)
312MD	12mm (DEEP)	320UM	20mm (UNIV)
313MD	13mm (DEEP)	321UM	21mm (UNIV)
314MD	14mm (DEEP)	322UM	22mm (UNIV)

Includes: Universal Joint (3301), 3" Impact Extension Bar (3303), 1/4" Bit Holder Socket (3306)



## 3/8" DRIVE METRIC MASTER IMPACT SOCKET SET

3329 SET OF 29

MODEL	SIZE	MODEL	SIZE
308M	8mm	308MD	8mm (DEEP)
309M	9mm	309MD	9mm (DEEP)
310M	10mm	310MD	10mm (DEEP)
311M	11mm	311MD	11mm (DEEP)
312M	12mm	312MD	12mm (DEEP)
313M	13mm	313MD	13mm (DEEP)
314M	14mm	314MD	14mm (DEEP)
315M	15mm	315MD	15mm (DEEP)
316M	16mm	316MD	16mm (DEEP)
317M	17mm	317MD	17mm (DEEP)
318M	18mm	318MD	18mm (DEEP)
319M	19mm	319MD	19mm (DEEP)
321M	21mm	321MD	21mm (DEEP)
322M	22mm	322MD	22mm (DEEP)

Includes: Universal Joint (3301)

3/8" DR.

3/8" DR.

3/8"  
DRIVE

## 3/8" DRIVE 12 POINT METRIC MASTER IMPACT SOCKET SET

3330 SET OF 29

MODEL	SIZE	MODEL	SIZE
308MZ	8mm	368208	8mm (DEEP)
309MZ	9mm	368209	9mm (DEEP)
310MZ	10mm	368210	10mm (DEEP)
311MZ	11mm	368211	11mm (DEEP)
312MZ	12mm	368212	12mm (DEEP)
313MZ	13mm	368213	13mm (DEEP)
314MZ	14mm	368214	14mm (DEEP)
315MZ	15mm	368215	15mm (DEEP)
316MZ	16mm	368216	16mm (DEEP)
317MZ	17mm	368217	17mm (DEEP)
318MZ	18mm	368218	18mm (DEEP)
319MZ	19mm	368219	19mm (DEEP)
321ZM	21mm	321ZMD	21mm (DEEP)
322ZM	22mm	322ZMD	22mm (DEEP)

Includes: Universal Joint (3301)

3/8"  
DRIVE

## 3/8" DRIVE SAE STANDARD IMPACT SOCKET SET

3360 SET OF 12

MODEL	SIZE	MODEL	SIZE
310	5/16"	322	11/16"
312	3/8"	324	3/4"
314	7/16"	326	13/16"
316	1/2"	328	7/8"
318	9/16"	330	15/16"
320	5/8"	332	1"

## 3/8" DRIVE SAE MID-DEPTH IMPACT SOCKET SET

3327 SET OF 13

3/8"  
DRIVE

MODEL	SIZE	MODEL	SIZE
310RD	5/16"	322RD	11/16"
312RD	3/8"	324RD	3/4"
314RD	7/16"	326RD	13/16"
316RD	1/2"	328RD	7/8"
318RD	9/16"	330RD	15/16"
320RD	5/8"	332RD	1"

Includes: Universal Joint (3301)

## 3/8" DRIVE 12 POINT SAE SEMI-DEEP IMPACT SOCKET SET

3337 SET OF 12

MODEL	SIZE	MODEL	SIZE
310ZRD	5/16"	322ZRD	11/16"
312ZRD	3/8"	324ZRD	3/4"
314ZRD	7/16"	326ZRD	13/16"
316ZRD	1/2"	328ZRD	7/8"
318ZRD	9/16"	330ZRD	15/16"
320ZRD	5/8"	332ZRD	1"



3/8" DR.

## 3/8" DRIVE 12 POINT SAE IMPACT SOCKET SET

3674 SET OF 12

MODEL	SIZE	MODEL	SIZE
310Z	5/16"	322Z	11/16"
312Z	3/8"	324Z	3/4"
314Z	7/16"	326Z	13/16"
316Z	1/2"	328Z	7/8"
318Z	9/16"	330Z	15/16"
320Z	5/8"	332Z	1"



## 3/8" DRIVE SAE DEEP IMPACT SOCKET SET

3361 SET OF 12

MODEL	SIZE	MODEL	SIZE
310D	5/16"	322D	11/16"
312D	3/8"	324D	3/4"
314D	7/16"	326D	13/16"
316D	1/2"	328D	7/8"
318D	9/16"	330D	15/16"
320D	5/8"	332D	1"



3/8" DR.

3/8"  
DRIVE

## 3/8" DRIVE 12 POINT SAE DEEP IMPACT SOCKET SET

3680 SET OF 12

MODEL	SIZE	MODEL	SIZE
36801	5/16"	36807	11/16"
36802	3/8"	36808	3/4"
36803	7/16"	36809	13/16"
36804	1/2"	368010	7/8"
36805	9/16"	368011	15/16"
36806	5/8"	368012	1"

3/8"  
DRIVE

## 3/8" DRIVE METRIC STANDARD IMPACT SOCKET SET

3358 SET OF 13

MODEL	SIZE	MODEL	SIZE
307M	7mm	314M	14mm
308M	8mm	315M	15mm
309M	9mm	316M	16mm
310M	10mm	317M	17mm
311M	11mm	318M	18mm
312M	12mm	319M	19mm
313M	13mm		

3/8"  
DRIVE

## 3/8" DRIVE METRIC MID-DEPTH IMPACT SOCKET SET

3328 SET OF 14

MODEL	SIZE	MODEL	SIZE
308MRD	8mm	315MRD	15mm
309MRD	9mm	316MRD	16mm
310MRD	10mm	317MRD	17mm
311MRD	11mm	318MRD	18mm
312MRD	12mm	319MRD	19mm
313MRD	13mm	321MRD	21mm
314MRD	14mm	322MRD	22mm

## 3/8" DRIVE 12 POINT METRIC SEMI-DEEP IMPACT SOCKET SET

3338 SET OF 13

MODEL	SIZE	MODEL	SIZE
307MZR	7mm	314MZR	14mm
308MZR	8mm	315MZR	15mm
309MZR	9mm	316MZR	16mm
310MZR	10mm	317MZR	17mm
311MZR	11mm	318MZR	18mm
312MZR	12mm	319MZR	19mm
313MZR	13mm		



3/8" DR.

## 3/8" DRIVE 12 POINT METRIC IMPACT SOCKET SET

3675 SET OF 13

MODEL	SIZE	MODEL	SIZE
307MZ	7mm	314MZ	14mm
308MZ	8mm	315MZ	15mm
309MZ	9mm	316MZ	16mm
310MZ	10mm	317MZ	17mm
311MZ	11mm	318MZ	18mm
312MZ	12mm	319MZ	19mm
313MZ	13mm		



## 3/8" DRIVE METRIC DEEP IMPACT SOCKET SET

3359 SET OF 13

MODEL	SIZE	MODEL	SIZE
307MD	7mm	314MD	14mm
308MD	8mm	315MD	15mm
309MD	9mm	316MD	16mm
310MD	10mm	317MD	17mm
311MD	11mm	318MD	18mm
312MD	12mm	319MD	19mm
313MD	13mm		



3/8" DR.

3/8"  
DRIVE

## 3/8" DRIVE 12 POINT METRIC DEEP IMPACT SOCKET SET

3682 SET OF 13

MODEL	SIZE	MODEL	SIZE
368207	7mm	368214	14mm
368208	8mm	368215	15mm
368209	9mm	368216	16mm
368210	10mm	368217	17mm
368211	11mm	368218	18mm
368212	12mm	368219	19mm
368213	13mm		

3/8"  
DRIVE

## 3/8" DRIVE SAE IMPACT SOCKET SET

3650 SET OF 8

MODEL	SIZE	MODEL	SIZE
310	5/16"	318	9/16"
312	3/8"	320	5/8"
314	7/16"	322	11/16"
316	1/2"	324	3/4"

3/8"  
DRIVE

## 3/8" DRIVE SAE DEEP IMPACT SOCKET SET

3652 Set of 8

MODEL	SIZE	MODEL	SIZE
310D	5/16"	318D	9/16"
312D	3/8"	320D	5/8"
314D	7/16"	322D	11/16"
316D	1/2"	324D	3/4"

## 3/8" DRIVE METRIC IMPACT SOCKET SET

3651 SET OF 8

MODEL	SIZE	MODEL	SIZE
309M	9mm	314M	14mm
310M	10mm	315M	15mm
311M	11mm	17M	17mm
313M	13mm	319M	19mm



3/8" DR.

## 3/8" DRIVE METRIC DEEP IMPACT SOCKET SET

3653 SET OF 8

MODEL	SIZE	MODEL	SIZE
309MD	9mm	314MD	14mm
310MD	10mm	315MD	15mm
311MD	11mm	317MD	17mm
313MD	13mm	319MD	19mm



## 3/8" DRIVE METRIC LOW PROFILE IMPACT SOCKET SET WITH HEX SHANK

- Hex shank drive
- Low profile design for limited clearance application

3362 SET OF 14

MODEL	SIZE	MODEL	SIZE
336201	6mm	336208	13mm
336202	7mm	336209	14mm
336203	8mm	336210	15mm
336204	9mm	336211	16mm
336205	10mm	336212	17mm
336206	11mm	336213	18mm
336207	12mm	336214	19mm



## 3/8" DRIVE SAE LOW PROFILE IMPACT SOCKET SET WITH HEX SHANK

- Hex shank drive
- Low profile design for limited clearance application

3363 SET OF 10

MODEL	SIZE	MODEL	SIZE
336301	1/4"	336306	1/2"
336302	9/32"	336307	9/16"
336303	5/16"	336308	5/8"
336304	3/8"	336309	11/16"
336305	7/16"	336310	3/4"

3/8" DR.

3/8"  
DRIVE

## 3/8" DRIVE SAE & METRIC LOW PROFILE IMPACT SOCKET SET WITH RATCHET

3325SR SET OF 25

MODEL	SIZE	MODEL	SIZE
336301	1/4"	336306	1/2"
336302	9/32"	336307	9/16"
336303	5/16"	336308	5/8"
336304	3/8"	336309	11/16"
336305	7/16"	336310	3/4"

MODEL	SIZE	MODEL	SIZE
336201	6mm	336208	13mm
336202	7mm	336209	14mm
336203	8mm	336210	15mm
336204	9mm	336211	16mm
336205	10mm	336212	17mm
336206	11mm	336213	18mm
336207	12mm	336214	19mm

Includes: 3/8" Drive 80 Tooth Low Profile Ratchet (30080)

3/8"  
DRIVE

## 3/8" DRIVE SAE LOW PROFILE IMPACT SOCKET SET WITH RATCHET

3311SR SET OF 11

MODEL	SIZE	MODEL	SIZE
336301	1/4"	336306	1/2"
336302	9/32"	336307	9/16"
336303	5/16"	336308	5/8"
336304	3/8"	336309	11/16"
336305	7/16"	336310	3/4"

Includes: 3/8" Drive 80 Tooth Low Profile Ratchet (30080)

3/8"  
DRIVE

## 3/8" DRIVE METRIC LOW PROFILE IMPACT SOCKET SET WITH RATCHET

3315SR Set of 15

MODEL	SIZE	MODEL	SIZE
336201	6mm	336208	13mm
336202	7mm	336209	14mm
336203	8mm	336210	15mm
336204	9mm	336211	16mm
336205	10mm	336212	17mm
336206	11mm	336213	18mm
336207	12mm	336214	19mm

Includes: 3/8" Drive 80 Tooth Low Profile Ratchet (30080)

## 3/8" DRIVE IMPACT EXTENSION SET

3500 SET OF 4

MODEL	SIZE	MODEL	SIZE
3503	3"	3510	10"
3505	5"	3515	15"



## 3/8" DRIVE LOCKING IMPACT EXTENSION SET

- Features a positive locking ball detent and sliding collar for quick release of sockets and accessories

3501 SET OF 3

MODEL	SIZE	MODEL	SIZE
3503	3"	3512	12"
3506	6"		



## 3/8" DRIVE IMPACT WOBBLE EXTENSION SET

- Steel ball retainer on male end
- Wobble drive provides 15° offset in all directions

3504 SET OF 4

MODEL	SIZE	MODEL	SIZE
3503W	3"	3510W	10"
3505W	5"	3515W	15"



3/8" DR.

3/8"  
DRIVE

## 3/8" DRIVE SAE UNIVERSAL IMPACT SOCKET SET

3654 SET OF 7

MODEL	SIZE	MODEL	SIZE
312U	3/8"	320U	5/8"
314U	7/16"	322U	11/16"
316U	1/2"	324U	3/4"
318U	9/16"		

3/8"  
DRIVE

## 3/8" DRIVE 12 POINT SAE UNIVERSAL IMPACT SOCKET SET

3690 SET OF 12

MODEL	SIZE	MODEL	SIZE
310UZ	5/16"	322UZ	11/16"
312UZ	3/8"	324UZ	3/4"
314UZ	7/16"	326UZ	13/16"
316UZ	1/2"	328UZ	7/8"
318UZ	9/16"	330UZ	15/16"
320UZ	5/8"	332UZ	1"

3/8"  
DRIVE

## 3/8" DRIVE SAE UNIVERSAL DEEP IMPACT SOCKET SET

3656 SET OF 7

MODEL	SIZE	MODEL	SIZE
312UD	3/8"	320UD	5/8"
314UD	7/16"	322UD	11/16"
316UD	1/2"	324UD	3/4"
318UD	9/16"		

3/8"  
DRIVE

## 3/8" DRIVE 12 POINT SAE UNIVERSAL DEEP IMPACT SOCKET SET

3677 SET OF 12

MODEL	SIZE	MODEL	SIZE
310ZUD	5/16"	322ZUD	11/16"
312ZUD	3/8"	324ZUD	3/4"
314ZUD	7/16"	326ZUD	13/16"
316ZUD	1/2"	328ZUD	7/8"
318ZUD	9/16"	330ZUD	15/16"
320ZUD	5/8"	332ZUD	1"

## 3/8" DRIVE METRIC UNIVERSAL IMPACT SOCKET SET

3655 Set of 7

MODEL	SIZE	MODEL	SIZE
310UM	10mm	316UM	16mm
313UM	13mm	317UM	17mm
314UM	14mm	318UM	18mm
315UM	15mm		



3/8" DR.

## 3/8" DRIVE METRIC UNIVERSAL IMPACT SOCKET SET

3657 SET OF 10

MODEL	SIZE	MODEL	SIZE
310UM	10mm	315UM	15mm
311UM	11mm	316UM	16mm
312UM	12mm	317UM	17mm
313UM	13mm	318UM	18mm
314UM	14mm	319UM	19mm



## 3/8" DRIVE 12 POINT METRIC UNIVERSAL IMPACT SOCKET SET

3691 SET OF 13

MODEL	SIZE	MODEL	SIZE
307ZUM	7mm	314ZUM	14mm
308ZUM	8mm	315ZUM	15mm
309ZUM	9mm	316ZUM	16mm
310ZUM	10mm	317ZUM	17mm
311ZUM	11mm	318ZUM	18mm
312ZUM	12mm	319ZUM	19mm
313ZUM	13mm		



## 3/8" DRIVE METRIC UNIVERSAL DEEP IMPACT SOCKET SET

3660 SET OF 10

MODEL	SIZE	MODEL	SIZE
310MD	10mm	315UMD	15mm
311UMD	11mm	316UMD	16mm
312UMD	12mm	317UMD	17mm
313UMD	13mm	318UMD	18mm
314UMD	14mm	319UMD	19mm



3/8" DR.

3/8"  
DRIVE

## 3/8" DRIVE 12 POINT METRIC UNIVERSAL DEEP IMPACT SOCKET SET

3678 SET OF 13

MODEL	SIZE	MODEL	SIZE
307MZUD	7mm	314MZUD	14mm
308MZUD	8mm	315MZUD	15mm
309MZUD	9mm	316MZUD	16mm
310MZUD	10mm	317MZUD	17mm
311MZUD	11mm	318MZUD	18mm
312MZUD	12mm	319MZUD	19mm
313MZUD	13mm		

3/8"  
DRIVE

## 3/8" DRIVE SAE UNIVERSAL HEX IMPACT DRIVER SET

3658 SET OF 7

MODEL	SIZE	MODEL	SIZE
365802	3/16"	365810	3/8"
365804	7/32"	365812	7/16"
365806	1/4"	365814	1/2"
365808	5/16"		

3/8"  
DRIVE

## 3/8" DRIVE METRIC UNIVERSAL HEX IMPACT DRIVER SET

3659 SET OF 7

MODEL	SIZE	MODEL	SIZE
365904	4mm	365908	8mm
365905	5mm	365910	10mm
365906	6mm	365912	12mm
365907	7mm		

## 3/8" DRIVE MASTER HEX BIT IMPACT SOCKET SET

• Includes most common hex sizes used for automotive repairs

3569 SET OF 84

### LONG IMPACT HEX DRIVERS

MODEL	SIZE	MODEL	SIZE
35471	3/16"	35484	4mm
35472	7/32"	35485	5mm
35473	1/4"	35486	6mm
35474	5/16"	35487	7mm
35475	3/8"	35488	8mm
35476	7/16"	354810	10mm
35477	1/2"	354812	12mm

### IMPACT HEX DRIVERS

MODEL	SIZE	MODEL	SIZE
36460	1/4"	364606	6mm
364601	5/16"	364607	7mm
364602	3/8"	364608	8mm
364603	7/16"	364610	10mm
364604	1/2"	364612	12mm
364605	9/16"	364614	14mm
364609	5/8"	364617	17mm
364611	3/4"	364619	19mm

### HEX IMPACT SOCKETS

MODEL	SIZE	MODEL	SIZE
36471	3/16"	36481	4mm
36472	7/32"	36482	5mm
36473	1/4"	36483	6mm
36474	5/16"	36484	7mm
36475	3/8"	36485	8mm
36476	7/16"	36486	9mm
36477	1/2"	36487	10mm
36478	9/16"	36488	12mm
36479	5/8"	36489	14mm

### STUBBY TRIPLE SQUARE IMPACT SOCKETS

MODEL	SIZE	MODEL	SIZE
304XZN	M4	310XZN	M10
305XZN	M5	312XZN	M12
306XZN	M6	314XZN	M14
308XZN	M8	316XZN	M16

### STUBBY TAMPERPROOF INTERNAL STAR IMPACT SOCKETS

MODEL	SIZE	MODEL	SIZE
310TH	T10H	330TH	T30H
315TH	T15H	340TH	T40H
320TH	T20H	345TH	T45H
325TH	T25H	347TH	T47H
327TH	T27H	350TH	T50H



### INTERNAL STAR IMPACT SOCKETS

MODEL	SIZE
3670S1	T20
3670S2	T25
3670S3	T27
3670S4	T30
3670S5	T40
3670S6	T45
3670S7	T47
3670S8	T50
3670S9	T55

### EXTERNAL STAR IMPACT SOCKETS

MODEL	SIZE
3670SE1	E5
3670SE2	E6
3670SE3	E7
3670SE4	E8
3670SE5	E10
3670SE6	E11
3670SE7	E12
3670SE8	E14
3670SE9	E16

3/8" DR.

3/8" DR.



## 3/8" DRIVE SAE & METRIC HEX IMPACT DRIVER SET

3649 SET OF 13

MODEL	SIZE	MODEL	SIZE
36471	3/16"	36475	3/8"
36472	7/32"	36476	7/16"
36473	1/4"	36477	1/2"
36474	5/16" & 8mm		

MODEL	SIZE	MODEL	SIZE
36481	4mm	36484	7mm
36482	5mm	36487	10mm
36483	6mm	36488	12mm



## 3/8" DRIVE SAE & METRIC STUBBY IMPACT HEX DRIVER SET

3646 SET OF 16

MODEL	SIZE	MODEL	SIZE
36460	1/4"	364604	1/2"
364601	5/16"	364605	9/16"
364602	3/8"	364609	5/8"
364603	7/16"	364611	3/4"

MODEL	SIZE	MODEL	SIZE
364606	6mm	364612	12mm
364607	7mm	364614	14mm
364608	8mm	364617	17mm
364610	10mm	364619	19mm



## 3/8" DRIVE SAE HEX IMPACT DRIVER SET

3647 SET OF 7

MODEL	SIZE	MODEL	SIZE
36471	3/16"	36475	3/8"
36472	7/32"	36476	7/16"
36473	1/4"	36477	1/2"
36474	5/16"		

## 3/8" DRIVE SAE STUBBY IMPACT HEX DRIVER SET

3644 SET OF 8

MODEL	SIZE	MODEL	SIZE
365600	1/4"	364605	9/16"
364602	3/8"	364609	5/8"
364603	7/16"	364613	11/16"
364604	1/2"	364611	3/4"



3/8"  
DRIVE



3/8" DR.

## 3/8" DRIVE EXTENDED LENGTH SAE IMPACT HEX DRIVER SET

3547 SET OF 7

MODEL	SIZE	MODEL	SIZE
35471	3/16"	35475	3/8"
35472	7/32"	35476	7/16"
35473	1/4"	35477	1/2"
35474	5/16"		



3/8"  
DRIVE



## 3/8" DRIVE METRIC HEX IMPACT DRIVER SET

3648 SET OF 7

MODEL	SIZE	MODEL	SIZE
36481	4mm	36485	8mm
36482	5mm	36487	10mm
36483	6mm	36488	12mm
36484	7mm		



3/8"  
DRIVE



3/8" DR.

3/8"  
DRIVE

## 3/8" DRIVE METRIC STUBBY IMPACT HEX DRIVER SET

3645 SET OF 8

MODEL	SIZE	MODEL	SIZE
365606	6mm	364612	12mm
364607	7mm	364614	14mm
364608	8mm	364617	17mm
364610	10mm	364619	19mm

3/8"  
DRIVE

## 3/8" DRIVE EXTENDED LENGTH METRIC IMPACT HEX DRIVER SET

3548 SET OF 7

MODEL	SIZE	MODEL	SIZE
35484	4mm	35488	8mm
35485	5mm	354810	10mm
35485	6mm	354812	12mm
35487	7mm		

3/8"  
DRIVE

## 3/8" DRIVE DEEP STUBBY TRIPLE SQUARE IMPACT BIT SOCKET SET

- One piece design for maximum durability

3640 SET OF 8

MODEL	SIZE	MODEL	SIZE
304XZN	M4	310XZN	M10
305XZN	M5	312XZN	M12
306XZN	M6	314XZN	M14
306XZN	M8	316XZN	M16

## 3/8" DRIVE DEEP STUBBY TAMPERPROOF IMPACT BIT SOCKET SET

- One piece design for maximum durability

3641 SET OF 11

MODEL	SIZE	MODEL	SIZE
310TH	T10H	335TH	T35H
315TH	T15H	340TH	T40H
320TH	T20H	345TH	T45H
325TH	T25H	347TH	T47H
327TH	T27H	350TH	T50H
330TH	T30H		



3/8" DR.

## 3/8" DRIVE STUBBY STAR BIT IMPACT BIT SOCKET SET

- One piece design for maximum durability

3643 SET OF 10

MODEL	SIZE	MODEL	SIZE
310T	T10	330T	T30
315T	T15	340T	T40
320T	T20	345T	T45
325T	T25	347T	T47
327T	T27	350T	T50



## 3/8" DRIVE STAR IMPACT SOCKET SET

3670S SET OF 9

MODEL	SIZE	MODEL	SIZE
3670S1	T20	3670S6	T45
3670S2	T25	3670S7	T47
3670S3	T27	3670S8	T50
3670S4	T30	3670S9	T55
3670S5	T40		



3/8" DR.

3/8"  
DRIVE

## 3/8" DRIVE INVERTED STAR IMPACT SOCKET SET

3670SE SET OF 9

MODEL	SIZE	MODEL	SIZE
3670SE1	E5	3670SE6	E11
3670SE2	E6	3670SE7	E12
3670SE3	E7	3670SE8	E14
3670SE4	E8	3670SE9	E16
3670SE5	E10		

3/8"  
DRIVE

## 3/8" DRIVE OIL FILTER SOCKET SET

- Forged from Chrome-Vanadium alloy steel

3671

WARNING: Use of this socket with an impact tool can cause serious injury.

## 3/8" DRIVE INDIVIDUAL OIL & FUEL FILTER SOCKETS

- Forged from Chrome-Vanadium alloy steel for maximum strength

MODEL	TYPE	MODEL	TYPE
367124	24mm Oil Filter Socket: Applicable for use on Buick with WT-V6 engines, Rendezvous Ultra, Lacrosse CSX, Cadillac WT-V6 - CTS, STS, SRX, and Saturn L3000	367135	35/36mm Oil Filter Socket: Applicable for use on BMW M52, M60, M62, M70, M73, MB, OM604, OM605, and OM606 engines; also fits Audi and VW models
367129	29mm Oil Filter Socket: Applicable for use on Dodge Cummins fuel filter housing 14700	367127	27mm Oil Filter Socket: Applicable for use on Cadillac STS 3.2 liter V6 and Mercedes Benz 1.8 liter 14 engines
367132	32mm Oil Filter Socket: Applicable for use on GM EcoTec and Saab engines	367138	38mm Oil Filter Socket: Vauxhaul Vectra 2.0 liter diesel engines

## 3/8" DRIVE PIPE PLUG SOCKET SET

3841 SET OF 11

MODEL	SIZE	TYPE
304PC	3/16"	Male Pipe Plug Socket
308EPC	1/4"	Female Pipe Plug Socket
308PC	1/4"	Male Pipe Plug Socket
309EPC	9/32"	Female Pipe Plug Socket
309PC	9/32"	Male Pipe Plug Socket
310EPC	5/16"	Female Pipe Plug Socket
310PC	5/16"	Male Pipe Plug Socket
311EPC	11/32"	Female Pipe Plug Socket
311PC	11/32"	Male Pipe Plug Socket
312EPC	3/8"	Female Pipe Plug Socket
312PC	3/8"	Male Pipe Plug Socket



3/8" DR.

## SLEEVE ADAPTER SET

- Low profile design
- Magnetic retention device keep the adapter attached to the socket
- Sleeve adapters can be stacked if additional drive reduction is needed
- Designed for impact or hand tool use

2342

MODEL	SIZE	MODEL	SIZE
3302	1/4" x 3/8"	4307	1/2" x 3/4"
2306	3/8" x 1/2"		



## 3/8" DRIVE EP24 INVERTED STAR PLUS IMPACT SOCKET

- Used to loosen and tighten all 2017 Ford truck bed bolts

324FTB



## 3/8" DRIVE 17MM CONVEX EXTRA THIN WALL WHEEL LUG SOCKET

- Forged from Chrome-Vanadium alloy steel
- Designed for damage-free removal of ABS pressure switch  
Removes and installs Bendix 10 ABS pressure switch on a 1990 or newer Dodge Monaco, Eagle Premier, and 1991 and newer Chrysler, Plymouth, and Dodge minivans

10212

WARNING: Use of this socket with an impact tool can cause serious injury.



3/8" DR.

3/8"  
DRIVE

## 3/8" DRIVE SWITCH SOCKET CHEVROLET

- Forged from Chrome-Vanadium alloy steel
- Oil pressure switch socket fits 1" and 1-1/16" on GM and Chrysler vehicles

10007

WARNING: Use of this socket with an impact tool can cause serious injury.

3/8"  
DRIVE

## 3/8" DRIVE 5/8" EXTENDED SPARKPLUG SOCKET

- Length 4.5"
- Designed for easy removal and installation of recessed, hard to reach spark plugs that are often deep within a tube

10008

WARNING: Use of this socket with an impact tool can cause serious injury.

3/8"  
DRIVE

## 3/8" DRIVE FUEL FILTER BANJO BOLT SOCKET

- Designed for use on most 1986 and later fuel-injected, Honda and Acura vehicles
- This socket is designed to easily remove and install the uniquely designed banjo bolt used to attach the fuel to the fuel filter

10005

WARNING: Use of this socket with an impact tool can cause serious injury.

## 3/8" DRIVE INDIVIDUAL SAE SOCKETS

SIZE	STANDARD	DEEP	UNIVERSAL	DEEP UNIV.	MAGNETIC	12 POINT	12 PT UNIV.	12 PT. DEEP	12 PT. UNIV./DEEP
SAE	MODEL	MODEL	MODEL	MODEL	MODEL	MODEL	MODEL	MODEL	MODEL
1/4"					308MG				
5/16"	310	310D	310U	310UD	310MG	310Z	310UZ	36801	310ZUD
3/8"	312	312D	312U	312UD	312MG	312Z	312UZ	36802	312ZUD
7/16"	314	314D	314U	314UD	314MG	314Z	314UZ	36803	314ZUD
1/2"	316	316D	316U	316UD	316MG	316Z	316UZ	36804	316ZUD
9/16"	318	318D	318U	318UD	318MG	318Z	318UZ	36805	318ZUD
5/8"	320	320D	320U	320UD	320MG	320Z	320UZ	36806	
11/16"	322	322D	322U	322UD	322MG	322Z	322UZ	36807	
3/4"	324	324D	324U	324UD	324MG	324Z	324UZ	36808	
13/16"	326	326D	326U	326UD		326Z	326UZ	36809	
7/8"	328	328D	328U	328UD		328Z	328UZ	368010	
15/16"	330	330D				330Z	330UZ	368011	
1"	332	332D				332Z	332UZ	368012	

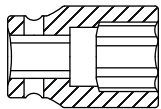

Standard

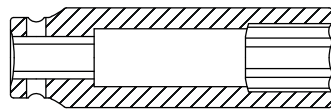

Deep

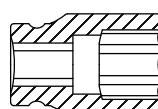

Magnetic

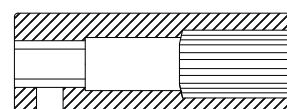

12 Point

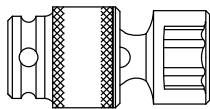

Universal

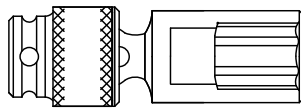

Deep Universal

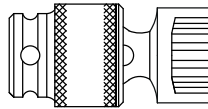

12 Point Universal

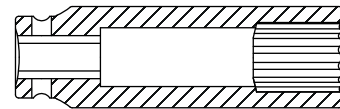

12 Point Deep

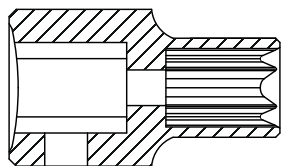

## 3/8" DRIVE INDIVIDUAL EXTERNAL STAR SOCKETS

MODEL	SIZE	MODEL	SIZE
304SE	E4	3670S35	E10
3670SE1	E5	3670SE6	E11
3670SE2	E6	3670SE7	E12
3670SE3	E7	3670SE8	E14
3670SE4	E8	3670SE9	E16

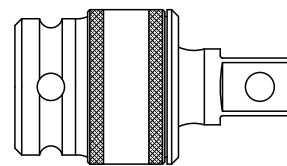

## 3/8" DRIVE INDIVIDUAL UNIVERSAL JOINT

MODEL	SIZE
3301	Universal Joint

## 3/8" DRIVE INDIVIDUAL METRIC SOCKETS

SIZE	STANDARD	DEEP	UNIVERSAL	DEEP UNIV.	MAGNETIC	12 POINT	12 PT. UNIV.	12 PT. DEEP	12 PT. UNIV./DEEP
METRIC	MODEL	MODEL	MODEL	MODEL	MODEL	MODEL	MODEL	MODEL	MODEL
7mm	307M	307MD			307MMG	307MZ	307ZUM	368207	307MZUD
8mm	308M	308MD			308MMG	308MZ	308ZUM	368208	308MZUD
9mm	309M	309MD			309MMG	309MZ	309ZUM	368209	309MZUD
10mm	310M	310MD	310UM	310UMD	310MMG	310MZ	310ZUM	368210	310MZUD
11mm	311M	311MD	311UM	311UMD	311MMG	311MZ	311ZUM	368211	
12mm	312M	312MD	312UM	312UMD	312MMG	312MZ	312ZUM	368212	312MZUD
13mm	313M	313MD	313UM	313UMD	313MMG	313MZ	313ZUM	368213	313MZUD
14mm	314M	314MD	314UM	314UMD	314MMG	314MZ	314ZUM	368214	314MZUD
15mm	315M	315MD	315UM	315UMD	315MMG	315MZ	315ZUM	368215	315MZUD
16mm	316M	316MD	316UM	316UMD	316MMG	316MZ	316ZUM	368216	316MZUD
17mm	317M	317MD	317UM	317UMD	317MMG	317MZ	317ZUM	368217	317MZUD
18mm	318M	318MD	318UM	318UMD	318MMG	318MZ	318ZUM	368218	318MZUD
19mm	319M	319MD	319UM	319UMD	319MMG	319MZ	319ZUM	368219	319MZUD
20mm	320M	320MD	320UM	320UMD					
21mm	321M	321MD	321UM	321UMD				321ZMD	
22mm	322M	322MD	322UM	322UMD				322ZMD	

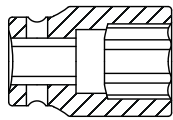

Standard

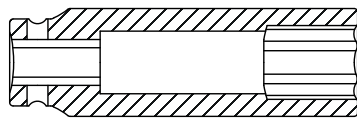

Deep

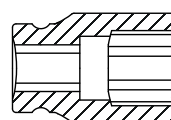

Magnetic

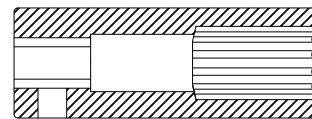

12 Point

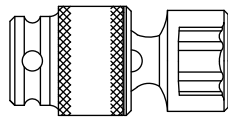

Universal

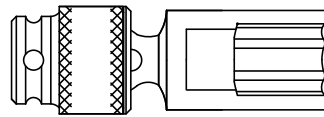

Deep Universal

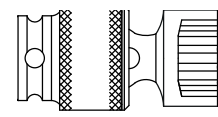

12 Point Universal

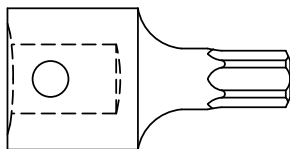

## 3/8" DRIVE INDIVIDUAL INTERNAL STAR SOCKETS

MODEL	SIZE	MODEL	SIZE
3670S1	T20	3670S6	T45
3670S2	T25	3670S7	T47
3670S3	T27	3670S8	T50
3670S4	T30	3670S9	T55
3670S5	T40		



## 1/2" DRIVE SAE MASTER IMPACT SOCKET SET

2568 SET OF 43

MODEL	SIZE	MODEL	SIZE
212	3/8"	212	3/8" (DEEP)
214	7/16"	214	7/16" (DEEP)
216	1/2"	216	1/2" (DEEP)
218	9/16"	218	9/16" (DEEP)
220	5/8"	220	5/8" (DEEP)
222	11/16"	222	11/16" (DEEP)
224	3/4"	224	3/4" (DEEP)
226	13/16"	226	13/16" (DEEP)
228	7/8"	228	7/8" (DEEP)
230	15/16"	230	15/16" (DEEP)
232	1"	232	1" (DEEP)
234	1-1/16"	234	1-1/16" (DEEP)
236	1-1/8"	236	1-1/8" (DEEP)
238	1-3/16"	238	1-3/16" (DEEP)
240	1-1/4"	240	1-1/4" (DEEP)
242	1-5/16"	242	1-5/16" (DEEP)
244	1-3/8"	244	1-3/8" (DEEP)
246	1-7/16"	246	1-7/16" (DEEP)
248	1-1/2"	248	1-1/2" (DEEP)

Includes: 4 Impact Extension Bars - 3" (2503), 5" (2505), 10" (2510), 15" (2515), Universal Joint (2300)



## 1/2" DRIVE METRIC MASTER IMPACT SOCKET SET

2569 SET OF 43

MODEL	SIZE	MODEL	SIZE
212M	9mm	212MD	9mm (DEEP)
210M	10mm	210MD	10mm (DEEP)
211M	11mm	211MD	11mm (DEEP)
212M	12mm	212MD	12mm (DEEP)
213M	13mm	213MD	13mm (DEEP)
214M	14mm	214MD	14mm (DEEP)
215M	15mm	215MD	15mm (DEEP)
216M	16mm	216MD	16mm (DEEP)
217M	17mm	217MD	17mm (DEEP)
218M	18mm	218MD	18mm (DEEP)
219M	19mm	219MD	19mm (DEEP)
220M	20mm	220MD	20mm (DEEP)
221M	21mm	221MD	21mm (DEEP)
222M	22mm	222MD	22mm (DEEP)
223M	23mm	223MD	23mm (DEEP)
224M	24mm	224MD	24mm (DEEP)
226M	26mm	226MD	26mm (DEEP)
227M	27mm	227MD	27mm (DEEP)
230M	30mm	230MD	30mm (DEEP)

Includes: 4 Impact Extension Bars - 3" (2503), 5" (2505), 10" (2510), 15" (2515), Universal Joint (2300)

1/2" DR.

1/2" DR.



## 1/2" DRIVE SAE MASTER IMPACT SOCKET SET

2668 SET OF 39

MODEL	SIZE	MODEL	SIZE
212	3/8"	212D	3/8" (DEEP)
214	7/16"	214D	7/16" (DEEP)
216	1/2"	216D	1/2" (DEEP)
218	9/16"	218D	9/16" (DEEP)
220	5/8"	220D	5/8" (DEEP)
222	11/16"	222D	11/16" (DEEP)
224	3/4"	224D	3/4" (DEEP)
226	13/16"	226D	13/16" (DEEP)
228	7/8"	228D	7/8" (DEEP)
230	15/16"	230D	15/16" (DEEP)
232	1"	232D	1" (DEEP)
234	1-1/16"	234D	1-1/16" (DEEP)
236	1-1/8"	236D	1-1/8" (DEEP)
238	1-3/16"	238D	1-3/16" (DEEP)
240	1-1/4"	240D	1-1/4" (DEEP)
242	1-5/16"	242D	1-5/16" (DEEP)
244	1-3/8"	244D	1-3/8" (DEEP)
246	1-7/16"	246D	1-7/16" (DEEP)
248	1-1/2"	248D	1-1/2" (DEEP)

Includes: Universal Joint (2300)



## 1/2" DRIVE 12 POINT SAE MASTER IMPACT SOCKET SET

2698 SET OF 39

MODEL	SIZE	MODEL	SIZE
212Z	3/8"	26701	3/8" (DEEP)
214Z	7/16"	26702	7/16" (DEEP)
216Z	1/2"	26703	1/2" (DEEP)
218Z	9/16"	26704	9/16" (DEEP)
220Z	5/8"	26705	5/8" (DEEP)
222Z	11/16"	26706	11/16" (DEEP)
224Z	3/4"	26707	3/4" (DEEP)
226Z	13/16"	26708	13/16" (DEEP)
228Z	7/8"	26709	7/8" (DEEP)
230Z	15/16"	267010	15/16" (DEEP)
232Z	1"	267011	1" (DEEP)
234Z	1-1/16"	267012	1-1/16" (DEEP)
236Z	1-1/8"	267013	1-1/8" (DEEP)
238Z	1-3/16"	267014	1-3/16" (DEEP)
240Z	1-1/4"	267015	1-1/4" (DEEP)
242Z	1-5/16"	242ZD	1-5/16" (DEEP)
244Z	1-3/8"	244ZD	1-3/8" (DEEP)
246Z	1-7/16"	246ZD	1-7/16" (DEEP)
248Z	1-1/2"	248ZD	1-1/2" (DEEP)

Includes: Universal Joint (2300)



## 1/2" DRIVE SAE DEEP IMPACT SOCKET SET

- Expanded size range includes deep impact sockets from 5/16 - 1-1/2"

2824 SET OF 24

MODEL	SIZE	MODEL	SIZE
210	5/16"	230	15/16"
212	3/8"	232	1"
214	7/16"	234	1-1/16"
216	1/2"	236	1-1/8"
218	9/16"	238	1-3/16"
220	5/8"	240	1-1/4"
222	11/16"	242	1-5/16"
224	3/4"	244	1-3/8"
226	13/16"	246	1-7/16"
228	7/8"	248	1-1/2"

Includes: 3 Impact Extension Bars: 3" (2503), 5" (2505), 10" (2510), Universal Joint (2300)



## 1/2" DRIVE SAE & METRIC MASTER DOUBLE DEEP IMPACT SOCKET SET

5153DD SET OF 29

MODEL	SIZE	MODEL	SIZE
214D	7/16"	228D	7/8"
216D	1/2"	230D	15/16"
218D	9/16"	232D	1"
220D	5/8"	234D	1-1/16"
222D	11/16"	236D	1-1/8"
224D	3/4"	240D	1-1/4"
226D	13/16"		

MODEL	SIZE	MODEL	SIZE
210MD	10mm	217MD	17mm
211MD	11mm	218MD	18mm
212MD	12mm	219MD	19mm
213MD	13mm	221MD	21mm
214MD	14mm	222MD	22mm
215MD	15mm	226MD	26mm
216MD	16mm	227MD	27mm

### DEEP FLIP SOCKETS

MODEL	SIZE	MODEL	SIZE
2701	3/4" x 13/16"	2704	19mm x 21mm

1/2" DR.

1/2" DR.



## 1/2" DRIVE METRIC MASTER IMPACT SOCKET SET

2669 SET OF 39

MODEL	SIZE	MODEL	SIZE
209M	9mm	209MD	9mm (DEEP)
210M	10mm	210MD	10mm (DEEP)
211M	11mm	211MD	11mm (DEEP)
212M	12mm	212MD	12mm (DEEP)
213M	13mm	213MD	13mm (DEEP)
214M	14mm	214MD	14mm (DEEP)
215M	15mm	215MD	15mm (DEEP)
216M	16mm	216MD	16mm (DEEP)
217M	17mm	217MD	17mm (DEEP)
218M	18mm	218MD	18mm (DEEP)
219M	19mm	219MD	19mm (DEEP)
220M	20mm	220MD	20mm (DEEP)
221M	21mm	221MD	21mm (DEEP)
222M	22mm	222MD	22mm (DEEP)
223M	23mm	223MD	23mm (DEEP)
224M	24mm	224MD	24mm (DEEP)
226M	26mm	226MD	26mm (DEEP)
227M	27mm	227MD	27mm (DEEP)
230M	30mm	230MD	30mm (DEEP)

Includes: Universal Joint (2300)



## 1/2" DRIVE 12 POINT METRIC MASTER IMPACT SOCKET SET

2699 Set of 39

MODEL	SIZE	MODEL	SIZE
209ZM	9mm	209ZMD	9mm (DEEP)
210ZM	10mm	210ZMD	10mm (DEEP)
211ZM	11mm	211ZMD	11mm (DEEP)
212ZM	12mm	212ZMD	12mm (DEEP)
213ZM	13mm	213ZMD	13mm (DEEP)
214ZM	14mm	214ZMD	14mm (DEEP)
215ZM	15mm	215ZMD	15mm (DEEP)
216ZM	16mm	216ZMD	16mm (DEEP)
217ZM	17mm	217ZMD	17mm (DEEP)
218ZM	18mm	218ZMD	18mm (DEEP)
219ZM	19mm	219ZMD	19mm (DEEP)
220ZM	20mm	220ZMD	20mm (DEEP)
221ZM	21mm	221ZMD	21mm (DEEP)
222ZM	22mm	222ZMD	22mm (DEEP)
223ZM	23mm	223ZMD	23mm (DEEP)
224ZM	24mm	224ZMD	24mm (DEEP)
226ZM	26mm	226ZMD	26mm (DEEP)
227ZM	27mm	227ZMD	27mm (DEEP)
230ZM	30mm	230ZMD	30mm (DEEP)

Includes: Universal Joint (2300)



## 1/2" DRIVE METRIC DEEP IMPACT SOCKET SET

2646 SET OF 26

MODEL	SIZE	MODEL	SIZE
210MD	10mm	223MD	23mm
211MD	11mm	224MD	24mm
212MD	12mm	225MD	25mm
213MD	13mm	226MD	26mm
214MD	14mm	227MD	27mm
215MD	15mm	228MD	28mm
216MD	16mm	229MD	29mm
217MD	17mm	230MD	30mm
218MD	18mm	232MD	32mm
219MD	19mm	233MD	33mm
220MD	20mm	234MD	34mm
221MD	21mm	235MD	35mm
222MD	22mm	236MD	36mm



## 1/2" DRIVE 12 POINT METRIC DEEP IMPACT SOCKET SET

2827 SET OF 26

MODEL	SIZE	MODEL	SIZE
267210	10mm	267223	23mm
267211	11mm	267224	24mm
267212	12mm	225ZMD	25mm
267213	13mm	226ZMD	26mm
267214	14mm	227ZMD	27mm
267215	15mm	228ZMD	28mm
267216	16mm	229ZMD	29mm
267217	17mm	230ZMD	30mm
267218	18mm	232ZMD	32mm
267219	19mm	233ZMD	33mm
267220	20mm	234ZMD	34mm
267221	21mm	235ZMD	35mm
267222	22mm	236ZMD	36mm

1/2" DR.

## 1/2" DRIVE SAE IMPACT SOCKET SET

2640 SET OF 19

MODEL	SIZE	MODEL	SIZE
212	3/8"	232	1"
214	7/16"	234	1-1/16"
216	1/2"	236	1-1/8"
218	9/16"	238	1-3/16"
220	5/8"	240	1-1/4"
222	11/16"	242	1-5/16"
224	3/4"	244	1-3/8"
226	13/16"	246	1-7/16"
228	7/8"	248	1-1/2"
230	15/16"		



1/2" DR.

1/2"  
DRIVE

## 1/2" DRIVE 12 POINT SAE IMPACT SOCKET SET

2819 SET OF 19

MODEL	SIZE	MODEL	SIZE
212Z	3/8"	232Z	1"
214Z	7/16"	234Z	1-1/16"
216Z	1/2"	236Z	1-1/8"
218Z	9/16"	238Z	1-3/16"
220Z	5/8"	240Z	1-1/4"
222Z	11/16"	242Z	1-5/16"
224Z	3/4"	244Z	1-3/8"
226Z	13/16"	246Z	1-7/16"
228Z	7/8"	248Z	1-1/2"
230Z	15/16"		

1/2"  
DRIVE

## 1/2" DRIVE SAE DEEP IMPACT SOCKET SET

2641 SET OF 19

MODEL	SIZE	MODEL	SIZE
212D	3/8"	232D	1"
214D	7/16"	234D	1-1/16"
216D	1/2"	236D	1-1/8"
218D	9/16"	238D	1-3/16"
220D	5/8"	240D	1-1/4"
222D	11/16"	242D	1-5/16"
224D	3/4"	244D	1-3/8"
226D	13/16"	246D	1-7/16"
228D	7/8"	248D	1-1/2"
230D	15/16"		

1/2"  
DRIVE

## 1/2" DRIVE 12 POINT SAE DEEP IMPACT SOCKET SET

2820 SET OF 19

MODEL	SIZE	MODEL	SIZE
26701	3/8"	267011	1"
26702	7/16"	267012	1-1/16"
26703	1/2"	267013	1-1/8"
26704	9/16"	267014	1-3/16"
26705	5/8"	267015	1-1/4"
26706	11/16"	242ZD	1-5/16"
26707	3/4"	244ZD	1-3/8"
26708	13/16"	246ZD	1-7/16"
26709	7/8"	248ZD	1-1/2"
267010	15/16"		

## 1/2" DRIVE METRIC IMPACT SOCKET SET

2645 SET OF 26

MODEL	SIZE	MODEL	SIZE
210M	10mm	223M	23mm
211M	11mm	224M	24mm
212M	12mm	225M	25mm
213M	13mm	226M	26mm
214M	14mm	227M	27mm
215M	15mm	228M	28mm
216M	16mm	229M	29mm
217M	17mm	230M	30mm
218M	18mm	232M	32mm
219M	19mm	233M	33mm
220M	20mm	234M	34mm
221M	21mm	235M	35mm
222M	22mm	236M	36mm



1/2" DR.

## 1/2" DRIVE 12 POINT METRIC IMPACT SOCKET SET

2826 SET OF 26

MODEL	SIZE	MODEL	SIZE
210ZM	10mm	223ZM	23mm
211ZM	11mm	224ZM	24mm
212ZM	12mm	225ZM	25mm
213ZM	13mm	226ZM	26mm
214ZM	14mm	227ZM	27mm
215ZM	15mm	228ZM	28mm
216ZM	16mm	229ZM	29mm
217ZM	17mm	230ZM	30mm
218ZM	18mm	232ZM	32mm
219ZM	19mm	233ZM	33mm
220ZM	20mm	234ZM	34mm
221ZM	21mm	235ZM	35mm
222ZM	22mm	236ZM	36mm



1/2" DR.

1/2"  
DRIVE

## 1/2" DRIVE SAE IMPACT SOCKET SET

2650 SET OF 13

MODEL	SIZE	MODEL	SIZE
214	7/16"	228	7/8"
216	1/2"	230	15/16"
218	9/16"	232	1"
220	5/8"	234	1-1/16"
222	11/16"	236	1-1/8"
224	3/4"	240	1-1/4"
226	13/16"		

1/2"  
DRIVE

## 1/2" DRIVE 12 POINT SAE IMPACT SOCKET SET

2678 SET OF 14

MODEL	SIZE	MODEL	SIZE
214Z	7/16"	228Z	7/8"
216Z	1/2"	230Z	15/16"
218Z	9/16"	232Z	1"
220Z	5/8"	234Z	1-1/16"
222Z	11/16"	236Z	1-1/8"
224Z	3/4"	238Z	1-3/16"
226Z	13/16"	240Z	1-1/4"

1/2"  
DRIVE

## 1/2" DRIVE SAE DEEP IMPACT SOCKET SET

2651 SET OF 13

MODEL	SIZE	MODEL	SIZE
214D	7/16"	228D	7/8"
216D	1/2"	230D	15/16"
218D	9/16"	232D	1"
220D	5/8"	234D	1-1/16"
222D	11/16"	236D	1-1/8"
224D	3/4"	240D	1-1/4"
226D	13/16"		

## 1/2" DRIVE 12 POINT SAE DEEP IMPACT SOCKET SET

2670 SET OF 15

MODEL	SIZE	MODEL	SIZE
26701	3/8"	26709	7/8"
26702	7/16"	26710	15/16"
26703	1/2"	26711	1"
26704	9/16"	26712	1-1/16"
26705	5/8"	26713	1-1/8"
26706	11/16"	26714	1-3/16"
26707	3/4"	26715	1-1/4"
26708	13/16"		



## 1/2" DRIVE SAE EXTRA LONG DEEP IMPACT SOCKET SET

2848 SET OF 8

MODEL	SIZE
216XD	1/2"
218XD	9/16"
220XD	5/8"
222XD	11/16"



## 1/2" DRIVE METRIC IMPACT SOCKET SET

• Add on set for: set# 2652

2692 SET OF 12

MODEL	SIZE	MODEL	SIZE
223M	23mm	230M	30mm
224M	24mm	232M	32mm
225M	25mm	233M	33mm
226M	26mm	234M	34mm
227M	27mm	235M	35mm
228M	28mm	236M	36mm



1/2" DR.



## 1/2" DRIVE 12 POINT METRIC IMPACT SOCKET SET

2679 SET OF 13

MODEL	SIZE	MODEL	SIZE
210ZM	10mm	217ZM	17mm
211ZM	11mm	218ZM	18mm
212ZM	12mm	219ZM	19mm
213ZM	13mm	221ZM	21mm
214ZM	14mm	222ZM	22mm
215ZM	15mm	224ZM	24mm
216ZM	16mm		

1/2"  
DRIVE

## 1/2" DRIVE METRIC EXTRA LONG DEEP IMPACT SOCKET SET

2851 SET OF 12

MODEL	SIZE	MODEL	SIZE
213MXD	13mm	219MXD	19mm
214MXD	14mm	220MXD	20mm
215MXD	15mm	221MXD	21mm
216MXD	16mm	222MXD	22mm
217MXD	17mm	223MXD	23mm
218MXD	18mm	224MXD	24mm

1/2"  
DRIVE

## 1/2" DRIVE METRIC IMPACT SOCKET SET

2652 SET OF 14

MODEL	SIZE	MODEL	SIZE
210M	10mm	217M	17mm
211M	11mm	218M	18mm
212M	12mm	219M	19mm
213M	13mm	221M	21mm
214M	14mm	222M	22mm
215M	15mm	226M	26mm
216M	16mm	227M	27mm

1/2"  
DRIVE

## 1/2" DRIVE METRIC DEEP IMPACT SOCKET SET

2653 SET OF 14

MODEL	SIZE	MODEL	SIZE
210MD	10mm	217MD	17mm
211MD	11mm	218MD	18mm
212MD	12mm	219MD	19mm
213MD	13mm	221MD	21mm
214MD	14mm	222MD	22mm
215MD	15mm	226MD	26mm
216MD	16mm	227MD	27mm



1/2" DR.

## 1/2" DRIVE 12 POINT METRIC DEEP IMPACT SOCKET SET

2672 SET OF 15

MODEL	SIZE	MODEL	SIZE
267210	10mm	267218	18mm
267211	11mm	267219	19mm
267212	12mm	267220	20mm
267213	13mm	267221	21mm
267214	14mm	267222	22mm
267215	15mm	267223	23mm
267216	16mm	267224	24mm
267217	17mm		



## 1/2" DRIVE METRIC EXTRA LONG DEEP IMPACT SOCKET SET

2852 SET OF 9

MODEL	SIZE	MODEL	SIZE
226MXD	26mm	231MXD	31mm
227MXD	27mm	232MXD	32mm
228MXD	28mm	233MXD	33mm
229MXD	29mm	234MXD	34mm
230MXD	30mm		



1/2" DR.



## 1/2" DRIVE 8 POINT SAE DEEP IMPACT SOCKET SET

2858 SET OF 13

MODEL	SIZE	MODEL	SIZE
212QD	3/8"	226QD	13/16"
214QD	7/16"	228QD	7/8"
216QD	1/2"	230QD	15/16"
218QD	9/16"	232QD	1"
220QD	5/8"	234QD	1-1/16"
222QD	11/16"	236QD	1-1/8"
224QD	3/4"		



## 1/2" DRIVE SAE EXTRA LONG DEEP IMPACT SOCKET SET

2845 SET OF 5

MODEL	SIZE	MODEL	SIZE
232XD	1"	240XD	1-1/4"
234XD	1-1/16"	242XD	1-5/16"
236XD	1-1/8"		



## 1/2" DRIVE SAE & METRIC EXTRA THIN WALL DEEP IMPACT SOCKET SET

2611 SET OF 11

MODEL	SIZE	MODEL	SIZE
2624	3/4"	2632	1"
2626	13/16"	2634	1-1/16"
2628	7/8"		
MODEL	SIZE	MODEL	SIZE
2617	17mm	2622	22mm
2619	19mm	2623	23mm
2621	21mm		

Includes: 3" Extension (2503)

## 1/2" DRIVE METRIC LOW PROFILE IMPACT SOCKET SET WITH HEX SHANK

- Hex shank drive
- Low profile design for limited clearance application

2673 SET OF 15

MODEL	SIZE	MODEL	SIZE
267301	10mm	267309	18mm
267302	11mm	267310	19mm
267303	12mm	267311	20mm
267304	13mm	267312	21mm
267305	14mm	267313	22mm
267306	15mm	267314	23mm
267307	16mm	267315	24mm
267308	17mm		



## 1/2" DRIVE SAE LOW PROFILE IMPACT SOCKET SET WITH HEX SHANK

- Hex shank drive
- Low profile design for limited clearance application

2674 SET OF 11

MODEL	SIZE	MODEL	SIZE
267401	3/8"	267407	3/4"
267402	7/16"	267408	13/16"
267403	1/2"	267409	7/8"
267404	9/16"	267410	15/16"
267405	5/8"	267411	1"
267406	11/16"		



## 1/2" DRIVE SAE UNIVERSAL IMPACT SOCKET SET

2644 SET OF 14

MODEL	SIZE	MODEL	SIZE
214U	7/16"	228U	7/8"
216U	1/2"	230U	15/16"
218U	9/16"	232U	1"
220U	5/8"	234U	1-1/16"
222U	11/16"	236U	1-1/8"
224U	3/4"	238U	1-3/16"
226U	13/16"	240U	1-1/4"



1/2" DR.

1/2"  
DRIVE

## 1/2" DRIVE 12 POINT SAE UNIVERSAL IMPACT SOCKET SET

2856 SET OF 15

MODEL	SIZE	MODEL	SIZE
212UZ	3/8"	228UZ	7/8"
214UZ	7/16"	230UZ	15/16"
216UZ	1/2"	232UZ	1"
218UZ	9/16"	234UZ	1-1/16"
220UZ	5/8"	236UZ	1-1/8"
222UZ	11/16"	238UZ	1-3/16"
224UZ	3/4"	240UZ	1-1/4"
226UZ	13/16"		

1/2"  
DRIVE

## 1/2" DRIVE SAE UNIVERSAL DEEP IMPACT SOCKET SET

2659 SET OF 10

MODEL	SIZE	MODEL	SIZE
213UD	3/8"	222UD	11/16"
214UD	7/16"	224UD	3/4"
216UD	1/2"	226UD	13/16"
218UD	9/16"	228UD	7/8"
220UD	5/8"	230UD	15/16"

1/2"  
DRIVE

## 1/2" DRIVE SAE UNIVERSAL IMPACT SOCKET SET

2657 SET OF 9

MODEL	SIZE	MODEL	SIZE
214U	7/16"	224U	3/4"
216U	1/2"	226U	13/16"
218U	9/16"	228U	7/8"
220U	5/8"	230U	15/16"
222U	11/16"		

## 1/2" DRIVE SAE UNIVERSAL IMPACT SOCKET SET

2654 SET OF 7

MODEL	SIZE	MODEL	SIZE
216U	1/2"	224U	3/4"
218U	9/16"	226U	13/16"
220U	5/8"	228U	7/8"
222U	11/16"		



1/2" DR.

## 1/2" DRIVE METRIC UNIVERSAL IMPACT SOCKET SET

2655 SET OF 7

MODEL	SIZE	MODEL	SIZE
213UM	13mm	217UM	17mm
214UM	14mm	218UM	18mm
215UM	15mm	219UM	19mm
216UM	16mm		



## 1/2" DRIVE METRIC UNIVERSAL IMPACT SOCKET SET

2665 SET OF 13

MODEL	SIZE	MODEL	SIZE
212UM	12mm	219UM	19mm
213UM	13mm	220UM	20mm
214UM	14mm	221UM	21mm
215UM	15mm	222UM	22mm
216UM	16mm	223UM	23mm
217UM	17mm	224UM	24mm
218UM	18mm		



1/2" DR.

1/2"  
DRIVE

## 1/2" DRIVE 12 POINT METRIC UNIVERSAL IMPACT SOCKET SET

2855 SET OF 15

MODEL	SIZE	MODEL	SIZE
210ZUM	10mm	218ZUM	18mm
211ZUM	11mm	219ZUM	19mm
212ZUM	12mm	220ZUM	20mm
213ZUM	13mm	221ZUM	21mm
214ZUM	14mm	222ZUM	22mm
215ZUM	15mm	223ZUM	23mm
216ZUM	16mm	224ZUM	24mm
217ZUM	17mm		

1/2"  
DRIVE

## 1/2" DRIVE METRIC UNIVERSAL DEEP IMPACT SOCKET SET

2658 SET OF 10

MODEL	SIZE	MODEL	SIZE
210UMD	10mm	215UMD	15mm
211UMD	11mm	216UMD	16mm
212UMD	12mm	217UMD	17mm
213UMD	13mm	218UMD	18mm
214UMD	14mm	219UMD	19mm

1/2"  
DRIVE

## 1/2" DRIVE 12 POINT METRIC UNIVERSAL DEEP IMPACT SOCKET SET

2662 SET OF 15

MODEL	SIZE	MODEL	SIZE
210MZUD	10mm	218MZUD	18mm
211MZUD	11mm	219MZUD	19mm
212MZUD	12mm	220MZUD	20mm
213MZUD	13mm	221MZUD	21mm
214MZUD	14mm	222MZUD	22mm
215MZUD	15mm	223MZUD	23mm
216MZUD	16mm	224MZUD	24mm
217MZUD	17mm		

## 1/2" DRIVE SAE UNIVERSAL HEX DRIVER IMPACT SOCKET SET

2748 SET OF 8

MODEL	SIZE	MODEL	SIZE
274806	1/4"	274814	1/2"
274808	5/16"	274816	9/16"
274810	3/8"	274818	5/8"
274812	7/16"	274820	3/4"



## 1/2" DRIVE METRIC UNIVERSAL HEX DRIVER IMPACT SOCKET SET

2749 SET OF 8

MODEL	SIZE	MODEL	SIZE
274906	6mm	274912	12mm
274907	7mm	274914	14mm
274908	8mm	274917	17mm
274910	10mm	274919	19mm



## 1/2" DRIVE 12 POINT SAE DRIVELINE LIMITED CLEARANCE SOCKET SET

- Great for most limited access fasteners
- Includes driveline sockets for Chevrolet, Chrysler, Dodge, Ford, GMC and Jeep models
- Remove and install driveline bolts, torque converters, cylinder heads, and 4x4 transmission casings

2696 SET OF 7

SIZE	SIZE
5/16"	3/8"
7/16"	1/2"
9/16"	11/16"
3/4"	



1/2" DR.

1/2"  
DRIVE

## 1/2" DRIVE 12 POINT METRIC DRIVELINE LIMITED CLEARANCE SOCKET SET

- Great for most limited access fasteners
- Includes driveline sockets for Chevrolet, Chrysler, Dodge, Ford, GMC and Jeep models
- Remove and install driveline bolts, torque converters, cylinder heads, and 4x4 transmission casings

2695 SET OF 7

SIZE	SIZE
8mm	10mm
11mm	12mm
13mm	14mm
15mm	16mm
17mm	

1/2"  
DRIVE

## 1/2" DRIVE IMPACT EXTENSION SET

- Steel ball retainer on male end

2500

MODEL	SIZE	MODEL	SIZE
2503	3"	2510	10"
2505	5"	2515	15"

1/2"  
DRIVE

## 1/2" DRIVE IMPACT LOCKING EXTENSION SET

- Features a positive locking ball detent and sliding collar for quick release of sockets and accessories

2501

MODEL	SIZE	MODEL	SIZE
2503L	3"	2512L	12"
2506	6"		

1/2"  
DRIVE

## 1/2" DRIVE IMPACT WOBBLE EXTENSION SET

- Steel ball retainer on male end
- Wobble drive provides 15° offset in all directions

2504

MODEL	SIZE	MODEL	SIZE
2503W	3"	2510W	10"
2505W	5"	2515W	15"

## 1/2" DRIVE TORQUE LIMITING SOCKET SET

- Made of flexible spring steel that stops turning when the required torque has been reached
- Torque limiting socket set will tighten wheel nuts to the correct torque on most makes and models of foreign and domestic cars, light trucks, and vans; these tools are designed for used with a 1/2" impact wrench

2880 SET OF 10

MODEL	SIZE
21755M	17mm / 55 ft. lbs. / 75 Nm
21780M	17mm / 80 ft. lbs. / 110 Nm
22180M	21mm / 80 ft. lbs. / 110 Nm
21910M	19mm (3/4") / 100 ft. lbs. / 135 Nm
21965M	19mm (3/4") / 65 ft. lbs. / 90 Nm
21980M	19mm (3/4") / 80 ft. lbs. 110 Nm
22212M	22mm (7/8") / 120 ft. lbs. / 160 Nm
22214M	22mm (7/8") / 140 ft. lbs. / 190 Nm

MODEL	SIZE
22610	13/16" / 100 ft. lbs. / 135 Nm
23014	15/16" / 140 ft. lbs. / 190 Nm



1/2" DRIVE

1/2" DR.

## INDIVIDUAL TRUCK TORQUE EXTENSIONS

- Provides the ability to torque inner and outer cap nuts and flange nuts on heavy duty trucks
- Torque sockets and extensions allow user to ensure that lug nuts are tightened to the required torque specification
- Designed to extend life of thin wall impact sockets

MODEL	SIZE
<b>3/4" DRIVE TRUCK TORQUE EXTENSIONS</b>	
4315TE	3/4" / 175 ft. lbs. / 240 Nm
4320TE	3/4" / 250 ft. lbs. / 350 Nm
4325TE	3/4" / 350 ft. lbs. / 475 Nm
4330TE	3/4" / 475 ft. lbs. / Nm
<b>1" DRIVE TRUCK TORQUE EXTENSIONS &amp; SOCKETS</b>	
5315TE	1" / 175 ft. lbs. / 240 Nm
5320TE	1" / 250 ft. lbs. / 350 Nm
5325TE	1" / 350 ft. lbs. / 475 Nm
5330TE	1" / 400 ft. lbs. / 545 Nm
5335TE	1" / 475 ft. lbs. / 650 Nm
5340TE	1" / 550 ft. lbs. / 750 Nm
5345TE	1" / 650 ft. lbs. / 880 Nm

MODEL	SIZE
<b>1" DRIVE TRUCK TORQUE EXTENDED SOCKET</b>	
533TS	33mm / 475 ft. lbs. / 650 nm
540TS	1 1/4" / 250 ft. lbs. / 350 Nm
548TS	1 1/2" / 475 ft. lbs. / 650 Nm



3/4" DRIVE

1" DRIVE

1/2" DR.

1/2"  
DRIVE

## 1/2" DRIVE TORQUE LIMITING EXTENSION SET

- Made of flexible spring steel that stops turning when the required torque has been reached
- This set contains the most popular sizes and torque ratings needed in the automotive service industry; torque limiting extensions often extend the life of thin wall impact sockets by limiting the torque to the required rating

2450 SET OF 5

MODEL	SIZE
2465	65 ft. lbs. Extension / 90 Nm
2480	80 ft. lbs. Extension / 110 Nm
24100	100 ft. lbs. Extension / 135 Nm
24120	120 ft. lbs. Extension / 160 Nm
24140	140 ft. lbs. Extension / 190 Nm

1/2"  
DRIVE

## 1/2" DRIVE SAE & METRIC MASTER IMPACT HEX DRIVER SET

2637 SET OF 20

MODEL	SIZE	MODEL	SIZE
26581	1/4"	26485	1/2"
264811	9/32"	26486	9/16"
26482	5/16"	26487	5/8"
26583	3/8"	26488	11/16"
26484	7/16"	26489	3/4"
MODEL	SIZE	MODEL	SIZE
26491	6mm	26497	14mm
26492	7mm	264912	15mm
26493	8mm	26499	17mm
26495	10mm	264913	18mm
26496	12mm	264910	19mm

1/2"  
DRIVE

## 1/2" DRIVE 6" LONG IMPACT HEX DRIVER MASTER SET

2637L SET OF 20

MODEL	SIZE	MODEL	SIZE
26481L	1/4"	264811L	9/32"
26482L	5/16"	26483L	3/8"
26484L	7/16"	26485L	1/2"
26486L	9/16"	26487L	5/8"
26488L	11/16"	26489L	3/4"
MODEL	SIZE	MODEL	SIZE
26491L	6mm	26492L	7mm
26493L	8mm	26495L	10mm
26496L	12mm	26497L	14mm
264912L	15mm	26499L	17mm
264913L	18mm	264910L	19mm

## 1/2" DRIVE SAE IMPACT HEX DRIVER SET

• Includes popular SAE hex sizes used for automotive repair

2638 SET OF 10

MODEL	SIZE	MODEL	SIZE
26581	1/4"	26485	1/2"
264811	9/32"	26486	9/16"
26482	5/16"	26487	5/8"
26583	3/8"	26488	11/16"
26484	7/16"	26489	3/4"



1/2" DR.

## 1/2" DRIVE 6" LONG SAE IMPACT HEX DRIVER MASTER SET

2638L SET OF 10

MODEL	SIZE	MODEL	SIZE
26481L	1/4"	264811L	9/32"
26482L	5/16"	26483L	3/8"
26484L	7/16"	26485L	1/2"
26486L	9/16"	26487L	5/8"
26488L	11/16"	26489L	3/4"



## 1/2" DRIVE METRIC IMPACT HEX DRIVER SET

2639 SET OF 10

MODEL	SIZE	MODEL	SIZE
26491	6mm	26497	14mm
26492	7mm	264912	15mm
26493	8mm	26499	17mm
26495	10mm	264913	18mm
26496	12mm	264910	19mm



1/2" DR.

1/2"  
DRIVE

## 1/2" DRIVE 6" LONG METRIC IMPACT HEX DRIVER MASTER SET

2639L SET OF 10

MODEL	SIZE	MODEL	SIZE
26491L	6mm	26492L	7mm
26493L	8mm	26495L	10mm
26496L	12mm	26497L	14mm
264912L	15mm	26499L	17mm
264913L	18mm	264910L	19mm

1/2"  
DRIVE

## 1/2" DRIVE INTERNAL STAR IMPACT SOCKET SET

2690S SET OF 8

MODEL	SIZE	MODEL	SIZE
2670S1	T30	2690S5	T50
2690S2	T40	2690S6	T55
2690S3	T45	2690S7	T60
2690S4	T47	2690S8	T70

1/2"  
DRIVE

## 1/2" DRIVE EXTERNAL STAR IMPACT SOCKET SET

2690SE SET OF 9

MODEL	SIZE	MODEL	SIZE
2670SE1	E10	2690SE6	E18
2690SE2	E11	2690SE7	E20
2690SE3	E12	2690SE8	E22
2690SE4	E14	2690SE9	E24
2690SE5	E16		

## 1/2" DRIVE METRIC THIN WALL WHEEL PROTECTOR IMPACT SOCKET

- Durable outer sleeve and insert protects high polished wheels and lug nuts from damage
- Fully guaranteed

2842 SET OF 3

1/2" DRIVE METRIC DEEP

MODEL	SIZE
284317	17mm
284319	19mm
284321	21mm



## 1/2" DRIVE METRIC THIN WALL WHEEL PROTECTOR IMPACT SOCKET

- Durable outer sleeve and insert protects high polished wheels and lug nuts from damage
- 150mm (5.9") length of these extra long thin wall sockets enable usage of a standard impact wrench, rather than one with a 2" anvil
- Fully guaranteed

2843 SET OF 3

1/2" DRIVE METRIC DEEP

MODEL	SIZE
284317	17mm
284319	19mm
284321	21mm



## 1/2" DRIVE EXTRA THIN WALL WHEEL PROTECTOR IMPACT SOCKET

- Durable outer sleeve and insert protects high polished wheels and lug nuts from damage

2849 SET OF 9

MODEL	SIZE	MODEL	SIZE
28492	3/4" (lt. green)	28498	15/16" (brown)
28494	13/16" (purple)	284910	1" (silver)
28496	7/8" (green)	284912	1-1/16" (black)
MODEL	SIZE	MODEL	SIZE
284917	17mm (blue)	284921	21mm (red)
284919	19mm (yellow)		



1/2" DR.



## HUB CAP AND WHEEL LOCK REMOVAL KIT

- Easily removes most lug nuts and wheel locks on most domestic and import passenger vehicles and light trucks

2840 SET OF 9

MODEL	SIZE
28401	Ford & Chrysler Hubcap Lock Remover
28402	Ford Wheel Lock Remover
28403	GM "M" & "F" Body Wheel Lock Remover
28404	Oversized Wheel Lock Remover
28405	McGard Wheel Lock Remover
28406	Lug Nut Extractor Punch
28407	Chrysler Hubcap Lock Remover
28408	GM Hubcap Lock Remover
28409	GM Spline Hubcap Lock Remover

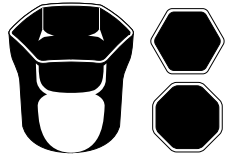
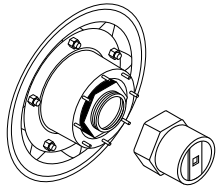

6 and 8 point locknut sockets fit rounded hex nuts found on Dana axles and some Ford trucks.

## WHEEL BEARING LOCKNUT SET

- For use with 1/2" ratchet or breaker bar

2847 SET OF 7

### ROUNDED HEX

MODEL	SIZE	MODEL	SIZE
28477	2-3/8"	28476	2-9/16"
28474	2-1/2"	28475	2-3/4"

### 6PT. HEX

MODEL	SIZE	MODEL	SIZE
28472	2-3/8"	28471	55mm
28473	2-1/2"		

WARNING: Use of this socket with an impact tool can cause serious injury.

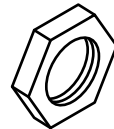

Measure from flat to flat to determine the size of the locknut. Refer to the chart above to determine which socket is best for your project.

## 1/2" DRIVE INDIVIDUAL WHEEL BEARING LOCKNUT SOCKETS

MODEL	SIZE	POINT	MODEL	SIZE	POINT	MODEL	SIZE	POINT	MODEL	SIZE	POINT
10600	2-3/32"	6	10609	3-1/2"	8	10618	2-1/4"	6	10626	2-7/8"	8
10601	2-3/8"	8	10610	3-7/8"	6	10619	2-5/8"	6	10627	3-1/8"	6
10602	2-9/16"	6	10611	3-7/8"	8	10620	2-3/4"	6	10628	3-1/8"	8
10603	2-9/16"	8	10612	4"	6	10629	2-3/4"	8	10630	4-1/2"	8
10604	3"	6	10613	4-1/8"	6	10621	3-3/8"	8	10631	5-1/4"	6
10605	3"	8	10614	4-3/8"	6	10622	3-3/4"	8	10632	4-1/8"	8
10606	3-1/4"	6	10615	4-3/8"	8	10623	3-3/4"	6	10633	4-13/16"	8
10607	3-1/4"	8	10616	4-7/8"	6	10624	3-13/16"	8			
10608	3-1/2"	6	10617	4-7/8"	8	10625	2-7/8"	6			

WARNING: Use of this socket with an impact tool can cause serious injury.

## 1/2" DRIVE METRIC DEEP SPINDLE NUT IMPACT SOCKET SET

• Deep design for GM & Chrysler spindle nut applications

2838 SET OF 4

MODEL	SIZE	MODEL	SIZE
2800	30mm	2834	34mm
2832	32mm	2802	36mm



1/2" DR.

## 1/2" DRIVE 12 POINT METRIC DEEP SPINDLE NUT IMPACT SOCKET SET

2837 SET OF 4

MODEL	SIZE	MODEL	SIZE
2800ZD	30mm	2806ZD	34mm
2804ZD	32mm	2802ZD	36mm



## 1/2" DRIVE METRIC DEEP SPINDLE NUT IMPACT SOCKET SET

• Deep design for GM & Chrysler spindle nut applications

2839 SET OF 7

MODEL	SIZE	MODEL	SIZE
2830	29mm	2806	35mm
2800	30mm	2802	36mm
2832	32mm	2803	38mm
2834	34mm		



## 1/2" DRIVE 12 POINT METRIC DEEP SPINDLE NUT IMPACT SOCKET SET

2835 SET OF 8

MODEL	SIZE	MODEL	SIZE
2801ZD	29mm	2803ZD	35mm
2800ZD	30mm	2802ZD	36mm
2804ZD	32mm	2805ZD	38mm
2806ZD	34mm	2807ZD	39mm



1/2" DR.

1/2"  
DRIVE

## 1/2" DRIVE INDIVIDUAL PIPE PLUG SOCKET SET

## 1/2" DRIVE PIPE PLUG SOCKET SET

2841 SET OF 8

MODEL	SIZE	TYPE
214FP	7/16"	Female Pipe Plug Socket
214P	7/16"	Male Pipe Plug Socket
216FP	1/2"	Female Pipe Plug Socket
216P	1/2"	Male Pipe Plug Socket
218FP	9/16"	Female Pipe Plug Socket
218P	9/16"	Male Pipe Plug Socket
220FP	5/8"	Female Pipe Plug Socket
220P	5/8"	Male Pipe Plug Socket

1/2"  
DRIVE

## 1/2" DRIVE SAE & METRIC DEEP THIN WALL FLIP SOCKET SET

2724 SET OF 4

MODEL	SIZE
2706	3/4" x 13/16" Thin Wall Flip Socket
2710	7/8" x 15/16" Thin Wall Flip Socket

MODEL	SIZE
2708	19mm x 21mm Deep Flip Socket

Includes: 3" Extension (2503)

1/2"  
DRIVE

## 1/2" DRIVE EP24 INVERTED STAR PLUS IMPACT SOCKET

- Used to loosen and tighten all 2017 Ford truck bed bolts

224FTB

1/2"  
DRIVE

## 1/2" DRIVE 5/8" 12 POINT DRIVELINE IMPACT SOCKET

- Designed for driveline applications and HD starters
- Eliminates the need for extensions and wobble sockets

220ZUDL

## 1/2" DRIVE 17mm CONVEX EXTRA THIN WALL WHEEL LUG SOCKET

- Non-marring socket for the safe and effective removal of the convex (flower head) lug nuts on late model Mercedes S, GLK, and CL Classes, and Maybach cars
- Precision design eliminates the need to replace the mangled lug nuts left behind by standard wheel lug sockets

2714

1/2"  
DRIVE



1/2" DR.

## 1/2" DRIVE SPANNER SOCKET FORD

- Forged from Chrome-Vanadium alloy steel
- Designed for use with 1985 and later Ford F250/F350 trucks with floating rear axle

10004

WARNING: Use of this socket with an impact tool can cause serious injury.

1/2"  
DRIVE



## 1/2" DRIVE AXLE FLANGE NUT SOCKET MERCEDES BENZ

- Forged from Chrome-Vanadium alloy steel
- Removes rear axle flange grooved nuts on Mercedes Benz models 107, 114, 115, 116, and 126 axles with CV joints when replacing axle seals and axle bearings

10203

WARNING: Use of this socket with an impact tool can cause serious injury.

1/2"  
DRIVE



## 1/2" DRIVE PENTAGON BRAKE IMPACT SOCKET

- Forged from Chrome-Vanadium alloy steel
- Pentagon shaped driver applicable for used on Citroën and Peugeot calipers

10210

WARNING: Use of this socket with an impact tool can cause serious injury.

1/2"  
DRIVE



1/2" DR.

1/2"  
DRIVE

## 1/2 X 60 X 76 FOUR WHEEL DRIVE SPINDLE NUT WRENCH

- Forged from Chrome-Vanadium alloy steel
- Applicable for use on 1984-92 Ford Ranger and Bronco II with manual hubs; 1986-95 For F-Series 1/2 ton pickup trucks; full size Bronco with Dana 44 front axle; 1990-93 Dodge trucks with Dana 44 automatic hubs

10200

WARNING: Use of this socket with an impact tool can cause serious injury.

1/2"  
DRIVE

## 1/2" DRIVE TIE ROD SOCKET

- Innovative, non-slip design
- Capable of removing most bolts that have 75% of their corners stripped away

2801

1/2"  
DRIVE

## 1/2" DRIVE 12MM 12 POINT FORD DRIVELINE SOCKET

- Specifically designed for driveline applications on Ford Mustang, Crown Victoria, Taurus, Explorer, Expedition, Excursion, Ranger, F150, and Mercury equivalents from 1980's to present

212ZUMDL

WARNING: Use of this socket with an impact tool can cause serious injury.

1/2"  
DRIVE

## 1/2" DRIVE 10MM 12 POINT HONDA HEAD BOLT SOCKET

- For use with 1976 to current Honda head bolts
- Overall length of 4-1/2"

210MZB

## 1/2" DRIVE 10MM 12 POINT NISSAN HEAD BOLT SOCKET

- For use with 1976 to Nissan head bolts
- Overall length of 4-1/2"

212MZB



1/2" DR.

## 1/2" DRIVE 14MM 12 POINT TOYOTA HEAD BOLT SOCKET

- For use with Toyota head bolts
- Overall length of 4-1/2"

214MZB



## 1/2" DRIVE 1-3/16" GM OIL PRESSURE SENDING UNIT SOCKET

- For use when removing or replacing oil pressure sending units on 1987 to newer GM engines including 2.0L, 2.5L, 2.8L, and 3.0L used in Chevy, Buick, Oldsmobile, Pontiac, and Cadillac; 1-3/16" hex - turn with 1/2" square drive tools or 15/16" wrench

10003

**WARNING:** Use of this socket with an impact tool can cause serious injury.



## 1/2" DRIVE CRANKCASE PULLEY SOCKET

- Forged from Chrome-Vanadium alloy steel for maximum strength
- Designed for use on most Honda/Acura engines for the removal and installation of the crankshaft pulley bolt

10006



1/2" DR.

1/2"  
DRIVE

## 3/8" & 1/2" DRIVE ADAPTER & UNIVERSAL JOINT IMPACT SET

3305

MODEL	SIZE	MODEL	SIZE
3301	3/8" Dr. Universal Joint	2301	1/2" (F) x 3/8" (M) Adapter
3300	3/8" (F) x 1/2" (M) Adapter	2302	1/2" (F) x 3/4" (M) Adapter
2300	1/2" Universal Joint		

1/2"  
DRIVE

## 1/4", 3/8", 1/2" DRIVE INTERNAL STAR IMPACT SOCKET SET

1820S SET OF 12

MODEL	SIZE	MODEL	SIZE
1820S1	T10 (1/4")	3670S5	T40 (3/8")
1820S2	T15 (1/4")	3670S6	T45 (3/8")
1820S3	T20 (1/4")	3670S7	T47 (3/8")
1820S4	T25 (1/4")	3670S8	T50 (3/8")
1820S5	T27 (1/4")	3670S9	T55 (3/8")
1820S6	T30 (1/4")	2690S7	T60 (1/2")

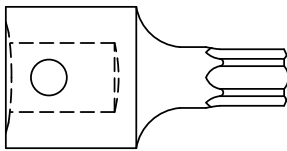

## 1/2" DRIVE INDIVIDUAL INTERNAL STAR SOCKETS

MODEL	SIZE	MODEL	SIZE
2690S1	T30	2690S5	T50
2690S2	T40	2690S6	T55
2690S3	T45	2690S7	T60
2690S4	T47	2690S8	T70

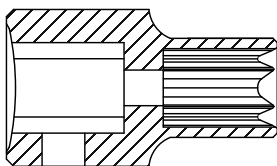

## 1/2" DRIVE INDIVIDUAL EXTERNAL STAR SOCKETS

MODEL	SIZE	MODEL	SIZE
2690SE1	E10	2690SE6	E18
2690SE2	E11	2690SE7	E20
2690SE3	E12	2690SE8	E22
2690SE4	E14	2690SE9	E24
2690SE5	E16		

## 1/2" DRIVE INDIVIDUAL UNIVERSAL JOINT

MODEL	SIZE
2300	Universal Joint

1/2" DRIVE

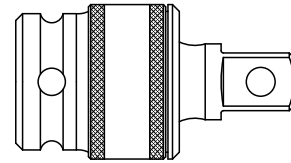

1/2" DR.

## 1/2" DRIVE INDIVIDUAL DEEP TRUCK WHEEL SOCKET SAE HEAVY DUTY

MODEL	SIZE
240HDD	1-1/4"

1/2" DRIVE

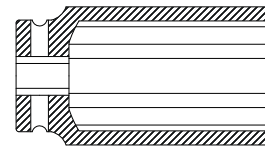

Heavy Duty Deep

## 1/2" DRIVE INDIVIDUAL SPECIALTY SOCKETS

MODEL	SIZE
2830	29mm Deep Spindle Nut
2800	30mm Deep Spindle Nut
2832	32mm Deep Spindle Nut
2834	34mm Deep Spindle Nut
2806	35mm Deep Spindle Nut
2802	36mm Deep Spindle Nut
2803	38mm Deep Spindle Nut
2801	Tie Rod Socket

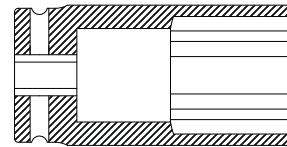

Deep Spindle Nut

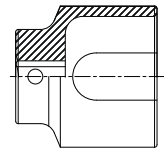

Tie Rod

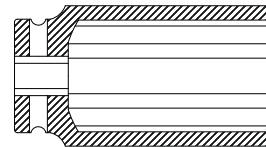

Heavy Duty Deep

1/2" DRIVE

## 1/2" DRIVE INDIVIDUAL WHEEL LOCK REMOVAL

MODEL	SIZE
28401	Ford & Chrysler Hubcap Locks
28402	Ford Wheel Locks & 18mm Lug Nuts
28403	Corvette, GM "M" & "F" Hubcap Locks
28404	Oversize McGard Wheel Locks
28405	McGard Wheel Locks and GM Hubcap Locks
28406	Extractor Punch
28407	Chrysler Hubcap Locks
28408	GM Hubcap Locks
28409	GM Spline Hubcap Locks

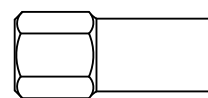

Hubcap Lock Removers

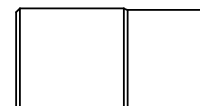
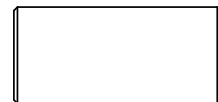

Lug Nut Remover

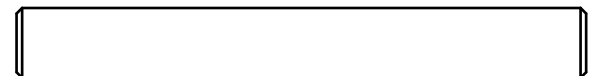

Extractor Punch

1/2" DRIVE

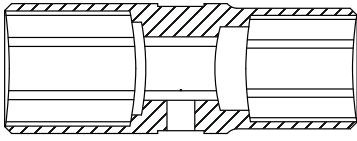

## 1/2" DRIVE INDIVIDUAL FLIP SOCKETS

MODEL	SIZE
2700	3/4" x 13/16"
2701	3/4" x 13/16" Deep
2706	3/4" x 13/16" Thin Wall
2710	7/8" x 15/16" Thin Wall
2712	1" x 1-1/16" Thin Wall
2707	17mm x 19mm
2705	17mm x 21mm Deep
2702	19mm x 21mm
2703	3/4" x 13/16" with 3" Extension Bar
2704	19mm x 21mm Deep
2708	19mm x 21mm Deep Thin Wall
2713	21mm x 22mm

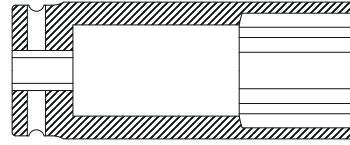

Deep Spindle Nut

## 1/2" DRIVE INDIVIDUAL SPINDLE NUT SOCKETS

### 12 PT. SPINDLE NUT DEEP

MODEL	SIZE	MODEL	SIZE
2801ZD	29mm	2803ZD	35mm
2800ZD	30mm	2802ZD	36mm
2804ZD	32mm	2805ZD	38mm
2806ZD	34mm	2807ZD	39mm

### SPINDLE NUT DEEP

MODEL	SIZE	MODEL	SIZE
2830	29mm	2806	35mm
2800	30mm	2802	36mm
2832	32mm	2803	38mm
2834	34mm		

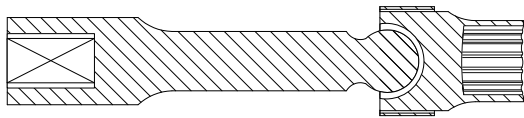

## 1/2" DRIVE INDIVIDUAL UNIVERSAL DRIVELINE 12 POINT DRIVE SAE & METRIC LIMITED CLEARANCE SOCKETS

MODEL	SIZE	MODEL	SIZE
210ZUDL	5/16"	218ZUDL	9/16"
212ZUDL	3/8"	222ZUDL	11/16"
214ZUDL	7/16"	224ZUDL	3/4"
216ZUDL	1/2"		

MODEL	SIZE	MODEL	SIZE
208ZUMDL	8mm	214ZUMDL	14mm
210ZUMDL	10mm	215ZUMDL	15mm
211ZUMDL	11mm	216ZUMDL	16mm
212ZUMDL	12mm	217ZUMDL	17mm
213ZUMDL	13mm		

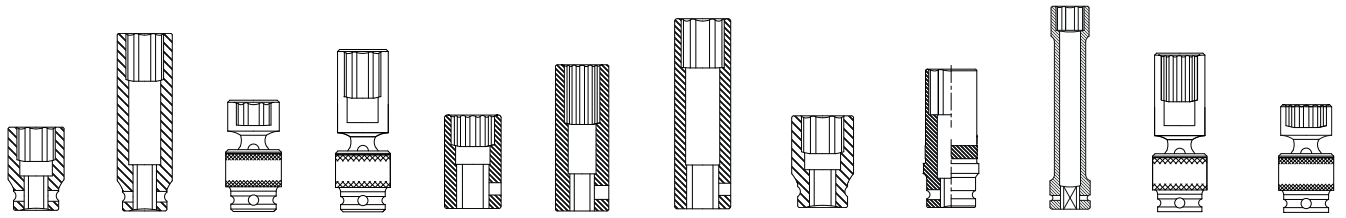

1/2" DR.

## 1/2" DRIVE INDIVIDUAL METRIC SOCKETS

SIZE	STD.	DEEP	UNIV.	DEEP UNIV.	12 PT.	12 PT. DEEP	EXTRA THIN WALL DEEP	MAGNETIC	WHEEL PROTECT.	EXTRA LONG DEEP	12 PT. DEEP UNIV.	12 PT. UNIV.
METRIC	MODEL	MODEL	MODEL	MODEL	MODEL	MODEL	MODEL	MODEL	MODEL	MODEL	MODEL	MODEL
8mm	208M	208MD								208MXD		
9mm	209M	209MD			209ZM	209ZMD				209MXD		
10mm	210M	210MD	210UM	210UMD	210ZM	267210		210MMG		210MXD	210MZUD	210ZUM
11mm	211M	211MD	211UM	211UMD	211ZM	267211		211MMG		211MXD	211MZUD	211ZUM
12mm	212M	212MD	212UM	212UMD	212ZM	267212		212MMG		212MXD	212MZUD	212ZUM
13mm	213M	213MD	213UM	213UMD	213ZM	267213		213MMG		213MXD	213MZUD	213ZUM
14mm	214M	214MD	214UM	214UMD	214ZM	267214		214MMG		214MXD	214MZUD	214ZUM
15mm	215M	215MD	215UM	215UMD	215ZM	267215		215MMG	284915	215MXD	215MZUD	215ZUM
16mm	216M	216MD	216UM	216UMD	216ZM	267216		216MMG		216MXD	216MZUD	216ZUM
17mm	217M	217MD	217UM	217UMD	217ZM	267217	2617	217MMG	284917	217MXD	217MZUD	217ZUM
18mm	218M	218MD	218UM	218UMD	218ZM	267218		218MMG		218MXD	218MZUD	218ZUM
19mm	219M	219MD	219UM	219UMD	219ZM	267219	2619	219MMG	284919	219MXD	219MZUD	219ZUM
20mm	220M	220MD	220UM	220UMD	220ZM	267220		220MMG		220MXD	220MZUD	220ZUM
21mm	221M	221MD	221UM	221UMD	221ZM	267221	2621	221MMG	284921	221MXD	221MZUD	221ZUM
22mm	222M	222MD	222UM	222UMD	222ZM	267222	2622			222MXD	222MZUD	222ZUM
23mm	223M	223MD	223UM	223UMD	223ZM	267223	2623			223MXD	223MZUD	223ZUM
24mm	224M	224MD	224UM	224UMD	224ZM	267224				224MXD	224MZUD	224ZUM
25mm	225M	225MD			225ZM	225ZMD				225MXD		
26mm	226M	226MD			226ZM	226ZMD				226MXD		
27mm	227M	227MD			227ZM	227ZMD				227MXD		
28mm	228M	228MD			228ZM	228ZMD				228MXD		
29mm	229M	229MD			229ZM	229ZMD				229MXD		
30mm	230M	230MD			230ZM	230ZMD				230MXD		
31mm	231M	231MD			231ZM	231ZMD				231MXD		
32mm	232M	232MD			232ZM	232ZMD				232MXD		
33mm	233M	233MD			233ZM	233ZMD				233MXD		
34mm	234M	234MD			234ZM	234ZMD				234MXD		
35mm	235M	235MD			235ZM	235ZMD				235MXD		
36mm	236M	236MD			236ZM	236ZMD				236MXD		
37mm										237MXD		
38mm										238MXD		

1/2" DR.

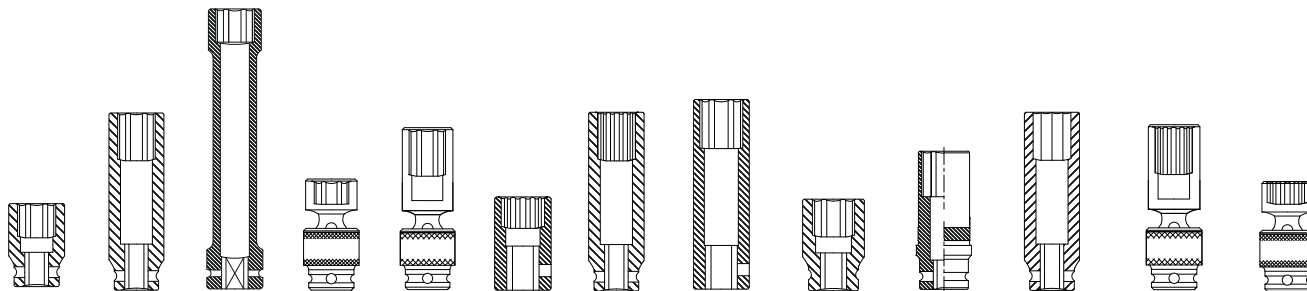

## 1/2" DRIVE INDIVIDUAL SAE SOCKETS

SIZE	STD.	DEEP	EXTRA LONG DEEP	UNIV.	DEEP UNIV.	12 PT.	12 PT. DEEP	EXTRA THIN WALL DEEP	MAGNETIC	WHEEL PROTECT.	8 PT. DEEP	12 PT. DEEP UNIV.	12 PT. UNIV.
SAE	MODEL	MODEL	MODEL	MODEL	MODEL	MODEL	MODEL	MODEL	MODEL	MODEL	MODEL	MODEL	MODEL
5/16"	210	210D	210XD										
3/8"	212	212D	212XD	212U	212UD	212Z	26701		212MG		212QD	212ZUD	212UZ
7/16"	214	214D	214XD	214U	214UD	214Z	26702		214MG		214QD	214ZUD	214UZ
1/2"	216	216D	216XD	216U	216UD	216Z	26703		216MG		216QD	216ZUD	216UZ
9/16"	218	218D	218XD	218U	218UD	218Z	26704		218MG		218QD	218ZUD	218UZ
5/8"	220	220D	220XD	220U	220UD	220Z	26705		220MG		220QD	220ZUD	220UZ
11/16"	222	222D	222XD	222U	222UD	222Z	26706		222MG		222QD	222ZUD	222UZ
3/4"	224	224D	224XD	224U	224UD	224Z	26707	2624	224MG	28492	224QD	224ZUD	224UZ
13/16"	226	226D	226XD	226U	226UD	226Z	26708	2626	226MG	28494	226QD	226ZUD	226UZ
7/8"	228	228D	228XD	228U	228UD	228Z	26709	2628	228MG	28496	228QD	228ZUD	228UZ
15/16"	230	230D	230XD	230U	230UD	230Z	267010		230MG	28498	230QD	230ZUD	230UZ
1"	232	232D	232XD	232U		232Z	267011	2632	232MG	284910	232QD	232ZUD	232UZ
1-1/16"	234	234D	234XD	234U		234Z	267012	2634		284912	234QD	234ZUD	234UZ
1-1/8"	236	236D	236XD	236U		236Z	267013				236QD	236ZUD	236UZ
1-3/16"	238	238D	238XD	238U		238Z	267014					238ZUD	238UZ
1-1/4"	240	240D	240XD	240U		240Z	267015					240ZUD	240UZ
1-5/16"	242	242D	242XD			242Z	242ZD						
1-3/8"	244	244D	244XD			244Z	244ZD						
1-7/16"	246	246D	246XD			246Z	246ZD						
1-1/2"	248	248D	248XD			248Z	248ZD						
1-9/16"	250	250D											
1-5/8"	252	252D											
1-11/16"	254	254D											
1-3/4"	256	256D											
1-13/16"	258	258D											
1-7/8"	260	260D											
1-15/16"	262	262D											
2"	264	264D											
2-1/16"	266	266D											
2-1/8"	268	268D											
2-3/16"	270	270D											
2-1/4"	272	272D											

## 3/4" DRIVE SAE IMPACT SOCKET SET

4696 SET OF 29

MODEL	SIZE	MODEL	SIZE
424	3/4"	454	1-11/16"
426	13/16"	456	1-3/4"
428	7/8"	458	1-13/16"
430	15/16"	460	1-7/8"
432	1"	462	1-15/16"
434	1-1/16"	464	2"
436	1-1/8"	466	2-1/16"
438	1-3/16"	468	2-1/8"
440	1-1/4"	470	2-3/16"
442	1-5/16"	472	2-1/4"
444	1-3/8"	474	2-5/16"
446	1-7/16"	476	2-3/8"
448	1-1/2"	478	2-7/16"
450	1-9/16"	480	2-1/2"
452	1-5/8"		



3/4" DR.

## 3/4" DRIVE SAE DEEP IMPACT SOCKET SET

4695 SET OF 29

MODEL	SIZE	MODEL	SIZE
424D	3/4"	454D	1-11/16"
426D	13/16"	456D	1-3/4"
428D	7/8"	458D	1-13/16"
430D	15/16"	460D	1-7/8"
432D	1"	462D	1-15/16"
434D	1-1/16"	464D	2"
436D	1-1/8"	466D	2-1/16"
438D	1-3/16"	468D	2-1/8"
440D	1-1/4"	470D	2-3/16"
442D	1-5/16"	472D	2-1/4"
444D	1-3/8"	474D	2-5/16"
446D	1-7/16"	476D	2-3/8"
448D	1-1/2"	478D	2-7/16"
450D	1-9/16"	480D	2-1/2"
452D	1-5/8"		



3/4" DR.

3/4"  
DRIVE

## 3/4" DRIVE METRIC IMPACT SOCKET SET

4692 SET OF 26

MODEL	SIZE	MODEL	SIZE
419M	19mm	433M	33mm
420M	20mm	434M	34mm
421M	21mm	435M	35mm
422M	22mm	436M	36mm
423M	23mm	438M	38mm
424M	24mm	439M	39mm
425M	25mm	440M	40mm
426M	26mm	441M	41mm
427M	27mm	442M	42mm
428M	28mm	443M	43mm
429M	29mm	444M	44mm
430M	30mm	446M	46mm
431M	31mm	450M	50mm

## 3/4" DRIVE METRIC DEEP IMPACT SOCKET SET

4693 SET OF 26

3/4"  
DRIVE

MODEL	SIZE	MODEL	SIZE
419MD	19mm	433MD	33mm
420MD	20mm	434MD	34mm
421MD	21mm	435MD	35mm
422MD	22mm	436MD	36mm
423MD	23mm	438MD	38mm
424MD	24mm	439MD	39mm
425MD	25mm	440MD	40mm
426MD	26mm	441MD	41mm
427MD	27mm	442MD	42mm
428MD	28mm	443MD	43mm
429MD	29mm	444MD	44mm
430MD	30mm	446MD	46mm
431MD	31mm	450MD	50mm

## 3/4" DRIVE SAE HEAVY DUTY IMPACT SOCKET SET

4683 SET OF 17

MODEL	SIZE	MODEL	SIZE
432	1"	450	1-9/16"
434	1-1/16"	452	1-5/8"
436	1-1/8"	454	1-11/16"
438	1-3/16"	456	1-3/4"
440	1-1/4"	458	1-13/16"
442	1-5/16"	460	1-7/8"
444	1-3/8"	462	1-15/16"
446	1-7/16"	464	2"
448	1-1/2"		



3/4" DR.

## 3/4" DRIVE SAE DEEP IMPACT SOCKET SET

4685 SET OF 17

MODEL	SIZE	MODEL	SIZE
432D	1"	450D	1-9/16"
434D	1-1/16"	452D	1-5/8"
436D	1-1/8"	454D	1-11/16"
438D	1-3/16"	456D	1-3/4"
440D	1-1/4"	458D	1-13/16"
442D	1-5/16"	460D	1-7/8"
444D	1-3/8"	462D	1-15/16"
446D	1-7/16"	464D	2"
448D	1-1/2"		



## 3/4" DRIVE METRIC HEAVY DUTY IMPACT SOCKET SET

4684 SET OF 17

MODEL	SIZE	MODEL	SIZE
426M	26mm	438M	38mm
427M	27mm	440M	40mm
428M	28mm	441M	41mm
429M	29mm	442M	42mm
430M	30mm	443M	43mm
432M	32mm	444M	44mm
433M	33mm	445M	45mm
435M	35mm	446M	46mm
436M	36mm		



3/4" DR.

3/4"  
DRIVE

## 3/4" DRIVE METRIC DEEP IMPACT SOCKET SET

4686 SET OF 17

MODEL	SIZE	MODEL	SIZE
426MD	26mm	436MD	36mm
427MD	27mm	438MD	38mm
428MD	28mm	439MD	39mm
429MD	29mm	440MD	40mm
430MD	30mm	441MD	41mm
431MD	31mm	442MD	42mm
432MD	32mm	443MD	43mm
433MD	33mm	444MD	44mm
435MD	35mm		

3/4"  
DRIVE

## 3/4" DRIVE SAE DEEP IMPACT SOCKET SET

4638 SET OF 14

MODEL	SIZE	MODEL	SIZE
424D	3/4"	438D	1-3/16"
426D	13/16"	440D	1-1/4"
428D	7/8"	442D	1-5/16"
430D	15/16"	444D	1-3/8"
432D	1"	446D	1-7/16"
434D	1-1/16"	448D	1-1/2"
436D	1-1/8"	452D	1-5/8"

3/4"  
DRIVE

## 3/4" DRIVE SAE IMPACT SOCKET SET

4680 SET OF 8

MODEL	SIZE	MODEL	SIZE
432	1"	442	1-5/16"
434	1-1/16"	444	1-3/8"
436	1-1/8"	446	1-7/16"
440	1-1/4"	448	1-1/2"

## 3/4" DRIVE SAE DEEP IMPACT SOCKET SET

4681 SET OF 8

MODEL	SIZE	MODEL	SIZE
432D	1"	442D	1-5/16"
434D	1-1/16"	444D	1-3/8"
436D	1-1/8"	446D	1-7/16"
440D	1-1/4"	448D	1-1/2"



## 3/4" DRIVE 12 POINT SAE THIN WALL IMPACT SOCKET SET

4687 SET OF 9

MODEL	SIZE	MODEL	SIZE
424ZT	3/4"	434ZT	1-1/16"
426ZT	13/16"	436ZT	1-1/8"
428ZT	7/8"	438ZT	1-3/16"
430ZT	15/16"	440ZT	1-1/4"
432ZT	1"		



## 3/4" DRIVE SAE HEX DRIVER IMPACT SOCKET SET

4506 SET OF 5

MODEL	SIZE	MODEL	SIZE
45061	3/4"	45064	1-1/8"
45062	7/8"	45065	1-1/4"
45063	1"		



## 3/4" DRIVE METRIC HEX DRIVER IMPACT SOCKET SET

4507 SET OF 5

MODEL	SIZE	MODEL	SIZE
450714	14mm	450722	22mm
450717	17mm	450724	24mm
450719	19mm		



3/4" DR.

3/4"  
DRIVE

## 3/4" DRIVE SAE TRUCK SERVICE IMPACT SOCKET SET

4682 SET OF 11

MODEL	SIZE	MODEL	SIZE
424	3/4"	434	1-1/16"
426	13/16"	436	1-1/8"
428	7/8"	438	1-3/16"
430	15/16"	440	1-1/4"
432	1"	448	1-1/2"

### SQUARE SOCKET

MODEL	SIZE
426S	13/16"

3/4"  
DRIVE

## 3/4" DRIVE TRUCK SERVICE METRIC IMPACT SOCKET SET

4011M SET OF 11

### DEEP SOCKETS

MODEL	SIZE	MODEL	SIZE
427MD	27mm	435MD	35mm
430MD	30mm	436MD	36mm
432MD	32mm	438MD	38mm
433MD	33mm	441MD	41mm

### SQUARE SOCKETS

MODEL	SIZE	MODEL	SIZE
417MSS	17mm	421MSS	21mm
420MS	20mm		

3/4"  
DRIVE

## 3/4" DRIVE METRIC TRUCK SERVICE IMPACT SOCKET SET

4070M SET OF 7

### DEEP SOCKETS

MODEL	SIZE	MODEL	SIZE
427M	27mm	435MD	35mm
430MD	30mm	441MD	41mm
433MD	33mm		

### SQUARE SOCKETS

MODEL	SIZE	MODEL	SIZE
417MSS	17mm	421MSS	21mm

## 3/4" DRIVE SAE & METRIC WHEEL SERVICE IMPACT SOCKET SET

4050 SET OF 5

### DEEP SOCKETS

MODEL	SIZE	MODEL	SIZE
434D	1-1/16"	448D	1-1/2"
440D	1-1/4"		

### DEEP SOCKET

MODEL	SIZE
433MD	33mm

### SQUARE SOCKET

MODEL	SIZE
426S	13/16"



3/4" DR.

## 3/4" DRIVE METRIC WHEEL SERVICE IMPACT SOCKET SET

4050M SET OF 5

### STANDARD SOCKETS

MODEL	SIZE	MODEL	SIZE
427M	27mm	430M	30mm

### DEEP SOCKETS

MODEL	SIZE	MODEL	SIZE
433MD	33mm	435MD	35mm

### SQUARE SOCKETS

MODEL	SIZE
417MSS	17mm



## 3/4" DRIVE WHEEL SERVICE IMPACT SOCKET SET

4632 SET OF 11

### DEEP POINT SOCKETS

MODEL	SIZE	MODEL	SIZE
424D	3/4"	432D	1"
426D	13/16"	438D	1-3/16"
428D	7/8"		

### DEEP POINT SOCKET

MODEL	SIZE
433MD	33mm

### THIN WALL DEEP SOCKETS

MODEL	SIZE	MODEL	SIZE
434DT	1-1/16"	440DT	1-1/4"
436DT	1-1/8"		

### DEEP BUDD WHEEL SOCKET

MODEL	SIZE
448DH	1-1/2"

### 4 POINT SQUARE SOCKET

MODEL	SIZE
426S	13/16"



3/4" DR.

3/4"  
DRIVE

SAE

METRIC

## 3/4" DRIVE COMBINATION BUDD WHEEL IMPACT SOCKET SET

4626 SET OF 4

### SQUARE BUDD WHEEL SOCKETS

MODEL	SIZE	MODEL	SIZE
4121C	41mm x 21mm	4826C	1-1/2" x 13/16"
43517B	35mm x 17mm		

### DEEP SOCKET

MODEL	SIZE
433MD	33mm

## 3/4" DRIVE TRUCK PINION LOCKNUT IMPACT SOCKET SET

- 7 extra thin wall deep impact sockets for removing or installing transmission and differential end yoke lock nuts on most trucks

4667 SET OF 7

3/4"  
DRIVE

SAE

MODEL	SIZE	MODEL	SIZE
464AN	2"	468AN	2-1/8"
472AN	2-1/4"	476AN	2-3/8"
480AN	2-1/2"	484AN	2-5/8"
488AN	2-3/4"		

## 3/4" & 1" DRIVE ADAPTER & UNIVERSAL JOINT IMPACT SET

4405



MODEL	SIZE	MODEL	SIZE
4304	3/4" Dr. Universal Joint	5303	1" (F) x 3/4" (M) Reducer
4301	3/4" (F) x 1/2" (M) Reducer	5304	1" Dr. Universal Joint
4300	3/4" (F) x 1" (M) Adapter		

## 3/4" DRIVE METRIC INDIVIDUAL TRUCK WHEEL SOCKETS HEAVY DUTY

SIZE	SQUARE	DOUBLE SQUARE	COMB. BUDD WHEEL	EXTRA LONG
METRIC	MODEL	MODEL	MODEL	MODEL
17mm		417MSS		
19mm	419MS			
20mm	420MS			
21mm		421MSS		
33mm				433MXL
35 X 20mm			43517B	
41 X 21mm			4121C	

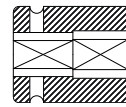

Square

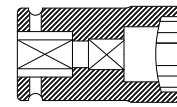

Combination Budd Wheel

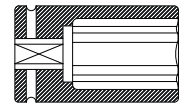

Deep Hex Budd Wheel

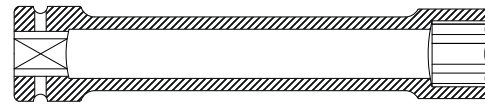

Extra Long

3/4" DR.

## 3/4" DRIVE SAE INDIVIDUAL TRUCK WHEEL SOCKETS HEAVY DUTY

SIZE	SQUARE	HEAVY DUTY SQUARE	DEEP THIN WALL	COMB. BUDD WHEEL	LIMITED DEPTH BUDD WHEEL	DEEP HEX BUDD WHEEL	EXTRA LONG
SAE	MODEL	MODEL	MODEL	MODEL	MODEL	MODEL	MODEL
13/16"	426S	426HDS					426XL
15/16"	430S						
1-1/16"			434DT				434XL
1-1/8"			436DT				436XL
1-1/4"			440DT				440XL
1-1/2"					448LD	448DH	448XL
1-1/2 x 13/16"				4826C			

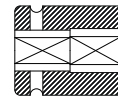

Square

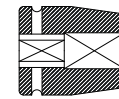

Heavy Duty Square



Deep Thin Wall

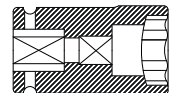

Combination Budd Wheel

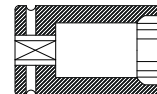

Limited Depth Budd Wheel

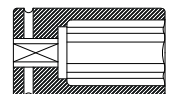

Deep Hex Budd Wheel

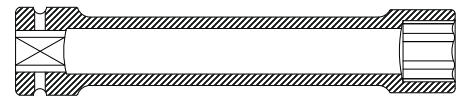

Extra Long

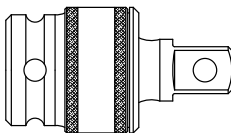

## 3/4" DRIVE INDIVIDUAL UNIVERSAL JOINT

MODEL	SIZE
4304	Universal Joint



## 3/4" DRIVE INDIVIDUAL RETAINING PIN & RING SET

MODEL	SIZE
4303	Pin & Ring Set

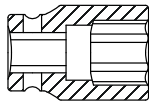

Standard

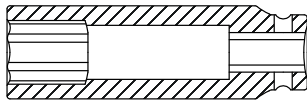

Deep

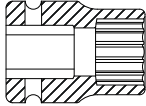

12 Point Thin Wall

## 3/4" DRIVE SAE INDIVIDUAL SOCKETS

SIZE	STANDARD	DEEP	12 POINT THIN WALL
SAE	MODEL	MODEL	MODEL
1/2"	416	416D	
9/16"	418	418D	
5/8"	420	420D	420ZT
11/16"	422	422D	422ZT
3/4"	424	424D	424ZT
13/16"	426	426D	426ZT
7/8"	428	428D	428ZT
15/16"	430	430D	430ZT
1"	432	432D	432ZT
1-1/16"	434	434D	434ZT
1-1/8"	436	436D	436ZT
1-3/16"	438	438D	438ZT
1-1/4"	440	440D	440ZT
1-5/16"	442	442D	
1-3/8"	444	444D	444ZT
1-7/16"	446	446D	
1-1/2"	448	448D	448ZT
1-9/16"	450	450D	
1-5/8"	452	452D	452ZT
1-11/16"	454	454D	
1-3/4"	456	456D	456ZT
1-13/16"	458	458D	
1-7/8"	460	460D	460ZT
1-15/16"	462	462D	
2"	464	464D	
2-1/16"	466	466D	
2-1/8"	468	468D	
2-3/16"	470	470D	
2-1/4"	472	472D	
2-5/16"	474	474D	
2-3/8"	476	476D	
2-7/16"	478	478D	
2-1/2"	480	480D	
2-9/16"	482	482D	
2-5/8"	484	484D	
2-11/16"	486	486D	
2-3/4"	488	488D	
2-13/16"	490	490D	
2-7/8"	492	492D	
2-15/16"	494	494D	
3"	496	496D	

## 3/4" DRIVE METRIC INDIVIDUAL SOCKETS

SIZE	STANDARD	DEEP	12 POINT THIN WALL
METRIC	MODEL	MODEL	MODEL
15mm			415MZT
16mm			416MZT
17mm			417MZT
18mm			418MZT
19mm	419M	419MD	419MZT
20mm	420M	420MD	420MZT
21mm	421M	421MD	421MZT
22mm	422M	422MD	422MZT
23mm	423M	423MD	423MZT
24mm	424M	424MD	424MZT
25mm	425M	425MD	425MZT
26mm	426M	426MD	426MZT
27mm	427M	427MD	427MZT
28mm	428M	428MD	428MZT
29mm	429M	429MD	429MZT
30mm	430M	430MD	430MZT
31mm	431M	431MD	
32mm	432M	432MD	432MZT
33mm	433M	433MD	433MZT
34mm	434M	434MD	
35mm	435M	435MD	435MZT
36mm	436M	436MD	436MZT
37mm			
38mm	438M	438MD	438MZT
39mm		439MD	
40mm	440M	440MD	440MZT
41mm	441M	441MD	
42mm	442M	442MD	
43mm	443M	443MD	
44mm	444M	444MD	
45mm	445M		
46mm	446M	446MD	
47mm	447M	447MD	
48mm	448M	448MD	
49mm	449M	449MD	
50mm	450M	450MD	
52mm	452M	452MD	
54mm	454M		
55mm	455M	455MD	
56mm	456M		
60mm	460M	460MD	
63mm	463M		
65mm	465M	465MD	

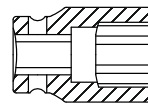

Standard

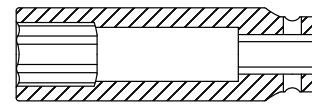

Deep

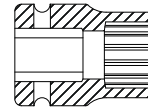

12 Point Thin Wall

1" DR.



**OVER 30"**  
in Height with Locking  
Case, Handle and Wheel Kit

## 1" DRIVE SAE IMPACT SOCKET SET

5692 SET OF 21

MODEL	SIZE	MODEL	SIZE
524	3/4"	546	1-7/16"
526	13/16"	548	1-1/2"
528	7/8"	550	1-9/16"
530	15/16"	552	1-5/8"
532	1"	554	1-11/16"
534	1-1/16"	556	1-3/4"
536	1-1/8"	558	1-13/16"
538	1-3/16"	560	1-7/8"
540	1-1/4"	562	1-15/16"
542	1-5/16"	564	2"
544	1-3/8"		



**OVER 30"**  
in Height with Locking  
Case, Handle and Wheel Kit

## 1" DRIVE SAE DEEP IMPACT SOCKET SET

5693 SET OF 21

MODEL	SIZE	MODEL	SIZE
524D	3/4"	546D	1-7/16"
526D	13/16"	548D	1-1/2"
528D	7/8"	550D	1-9/16"
530D	15/16"	552D	1-5/8"
532D	1"	554D	1-11/16"
534D	1-1/16"	556D	1-3/4"
536D	1-1/8"	558D	1-13/16"
538D	1-3/16"	560D	1-7/8"
540D	1-1/4"	562D	1-15/16"
542D	1-5/16"	564D	2"
544D	1-3/8"		



## 1" DRIVE SAE IMPACT SOCKET SET

5699 SET OF 9

MODEL	SIZE	MODEL	SIZE
532	1"	552	1-5/8"
536	1-1/8"	556	1-3/4"
540	1-1/4"	560	1-7/8"
544	1-3/8"	564	2"
548	1-1/2"		

## 1" DRIVE SAE DEEP IMPACT SOCKET SET

5681 SET OF 8

MODEL	SIZE	MODEL	SIZE
528D	7/8"	536D	1-1/8"
530D	15/16"	538D	1-3/16"
532D	1"	540D	1-1/4"
534D	1-1/16"	548D	1-1/2"



1" DR.

## 1" DRIVE METRIC DEEP IMPACT SOCKET SET

5697M SET OF 8

### DEEP SOCKETS

MODEL	SIZE	MODEL	SIZE
527MD	27mm	536MD	36mm
533MD	33mm	541MD	41mm
535MD	35mm		

### SQUARE SOCKETS

MODEL	SIZE	MODEL	SIZE
517MSS	17mm	521MSS	21mm



## 1" DRIVE SAE HEX DRIVER IMPACT SOCKET SET

5606 SET OF 6

MODEL	SIZE	MODEL	SIZE
56061	3/4"	56064	1-1/8"
56062	7/8"	56065	1-1/4"
56063	1"	56066	1-3/8"



## 1" DRIVE METRIC HEX DRIVER IMPACT SOCKET SET

5607 SET OF 6

MODEL	SIZE	MODEL	SIZE
560714	14mm	560722	22mm
560717	17mm	560724	24mm
560719	19mm	560727	27mm



1" DR.



## 1" DRIVE SAE & METRIC HEAVY DUTY WHEEL IMPACT SOCKET SET

5690A SET OF 10

### DEEP SOCKETS

MODEL	SIZE	MODEL	SIZE
532D	1"	556D	1-3/4"
538D	1-3/16"		

### DEEP SOCKET

MODEL	SIZE
533M	33mm

### DEEP THIN WALL SOCKETS

MODEL	SIZE	MODEL	SIZE
534DT	1-1/16"	540DT	1-1/4"
536DT	1-1/8"		

### SQUARE SOCKET

MODEL	SIZE	MODEL	SIZE
526S	13/16"	530S	15/16"

### CONTROLLED DEPTH SOC

MODEL	SIZE
548CDS	1-1/2"



## 1" DRIVE SAE & METRIC WHEEL SERVICE IMPACT SOCKET SET

5685 SET OF 5

### DEEP SOCKET

MODEL	SIZE	MODEL	SIZE
548D	1-1/2"	533MD	33mm

### DEEP THIN WALL SOCKETS

MODEL	SIZE	MODEL	SIZE
536DT	1-1/8"	540DT	1-1/4"

### SQUARE SOCKET

MODEL	SIZE
526S	13/16"



## 1" DRIVE SAE & METRIC WHEEL SERVICE IMPACT SOCKET SET

5688 SET OF 8

### STANDARD SOCKETS

MODEL	SIZE	MODEL	SIZE
528	7/8"	532	1"

### STANDARD SOCKET

MODEL	SIZE
533M	33mm

### DEEP THIN WALL SOCKETS

MODEL	SIZE	MODEL	SIZE
534DT	1-1/16"	540DT	1-1/4"
536DT	1-1/8"		

### SQUARE SOCKET

MODEL	SIZE
526S	13/16"

### CONTROLLED DEPTH SOCKET

MODEL	SIZE
548CDS	1-1/2"



## 1" DRIVE SAE & METRIC COMBINATION BUDD WHEEL IMPACT SOCKET SET

5626 SET OF 5

### SQUARE BUDD WHEEL SOCKET

MODEL	SIZE
5826C	1-1/2" x 13/16"

### SQUARE BUDD WHEEL SOCKETS

MODEL	SIZE	MODEL	SIZE
53517	35mm x 17mm	54121	41mm x 21mm
53820	38mm x 20mm		

### DEEP SOCKET

MODEL	SIZE
533MD	33mm



1" DR.

## 1" DRIVE SAE IMPACT SOCKET SET

5616 SET OF 14

MODEL	SIZE	MODEL	SIZE
566	2-1/16"	588	2-3/4"
580	2-1/2"	576	2-3/8"
568	2-1/8"	574	2-5/16"
586	2-11/16"	584	2-5/8"
590	2-13/16"	592	2-7/8"
594	2-15/16"	582	2-9/16"
570	2-3/16"	596	3"



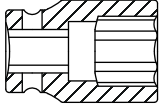

Standard

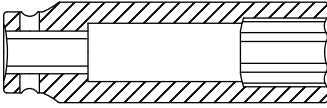

Deep

## 1" DRIVE SAE INDIVIDUAL SOCKETS

SIZE	STANDARD	DEEP	SIZE	STANDARD	DEEP
SAE	MODEL	MODEL	SAE	MODEL	MODEL
3/4"	524	524D	2-1/4"	572	572D
13/16"	526	526D	2-5/16"	574	574D
7/8"	528	528D	2-3/8"	576	576D
15/16"	530	530D	2-7/16"	578	578D
1"	532	532D	2-1/2"	580	580D
1-1/16"	534	534D	2-9/16"	582	582D
1-1/8"	536	536D	2-5/8"	584	584D
1-3/16"	538	538D	2-11/16"	586	586D
1-1/4"	540	540D	2-3/4"	588	588D
1-5/16"	542	542D	2-13/16"	590	590D
1-3/8"	544	544D	2-7/8"	592	592D
1-7/16"	546	546D	2-15/16"	594	594D
1-1/2"	548	548D	3"	596	596D
1-9/16"	550	550D	3-1/8"	5100	5100D
1-5/8"	552	552D	3-1/4"	5104	5104D
1-11/16"	554	554D	3-3/8"	5108	5108D
1-3/4"	556	556D	3-1/2"	5112	5112D
1-13/16"	558	558D	3-5/8"	5116	5116D
1-7/8"	560	560D	3-3/4"	5120	5120D
1-15/16"	562	562D	3-7/8"	5124	5124D
2"	564	564D	4"	5128	5128D
2-1/16"	566	566D	4-1/8"	5132	5132D
2-1/8"	568	568D	4-1/4"	5136	5136D
2-3/16"	570	570D	4-1/2"	5140	5140D

## 1" DRIVE SAE INDIVIDUAL TRUCK WHEEL SOCKETS HEAVY DUTY

SIZE	SQUARE	DEEP THIN WALL	EXTRA LONG	COMB. BUDD WHEEL	CONT. DEPTH	HEAVY DUTY SQUARE	EXTRA DEEP
SAE	MODEL	MODEL	MODEL	MODEL	MODEL	MODEL	MODEL
13/16"	526S					526HDS	
15/16"	530S						
1-1/16"		534DT					
1-1/8"		536DT					
1-1/4"		540DT	540EL				
1-5/16"		542DT					
1-1/2"		548DT			548CDS		
1-3/4"							556XD
1-1/2" X 13/16"				5826C			

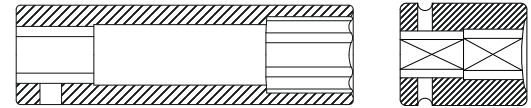

Deep Thin Wall

Square



Extra Long

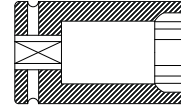

Controlled Depth

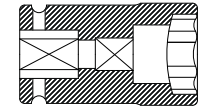

Combination Budd Wheel

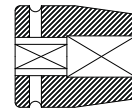

Heavy Duty Square

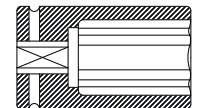

Extra Deep

## 1" DRIVE METRIC INDIVIDUAL SOCKETS

SIZE	STANDARD	DEEP	SIZE	STANDARD	DEEP
METRIC	MODEL	MODEL	METRIC	MODEL	MODEL
19mm	519M	519MD	38mm	538M	538MD
21mm	521M	521MD	40mm	540M	540MD
22mm	522M	522MD	41mm	541M	541MD
23mm	523M	523MD	42mm	542M	542MD
24mm	524M	524MD	46mm	546M	546MD
25mm	525M	525MD	50mm	550M	550MD
26mm	526M	526MD	52mm	552M	
27mm	527M	527MD	54mm	554M	554MD
28mm	528M		55mm	555M	555MD
29mm	529M	529MD	56mm	556M	556MD
30mm	530M	530MD	58mm	558M	558MD
32mm	532M	532MD	60mm	560M	560MD
33mm	533M	533MD	65mm	565M	565MD
35mm	535M	535MD	70mm	570M	570MD
36mm	536M	536MD			

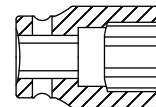

Standard



Deep

1" DR.

1" DR.

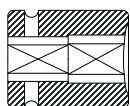

Square



Extra Long



Deep Thin Wall

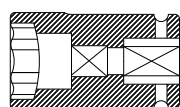

Combination Budd Wheel

## 1" DRIVE METRIC INDIVIDUAL TRUCK WHEEL SOCKETS HEAVY DUTY

SIZE	SQUARE	DEEP THIN WALL	EXTRA LONG	COMB. BUDD WHEEL
METRIC	MODEL	MODEL	MODEL	MODEL
17mm	517MSS			
19mm	519MS			
20mm	520MS			
21mm	521MSS			
33mm			533MEL	
41mm		541MDT		
35 x 17mm				53517
38mm				53820
41 x 21mm				54121

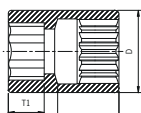

Standard

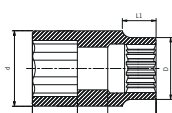

Deep

## #5 SPLINE DRIVE SAE INDIVIDUAL SOCKETS

SIZE	STANDARD	DEEP	SIZE	STANDARD	DEEP
SAE	MODEL	MODEL	SAE	MODEL	MODEL
7/8"	5500S		1-13/16"	5536	
15/16"	5525		1-7/8"	5508	
1-1/16"	5526		1-15/16"	5537	
1-1/8"	5502		2"	5509	
1-3/16"	5504		2-1/8"	5568	
1-1/4"	5503		2-1/4"	5572	
1-5/16"	5534		2-3/8"	5576	
1-3/8"	5533		2-1/2"	5580	
1-7/16"	5535		2-5/8"	5584	
1-1/2"	5505	5548D	2-3/4"	5588	
1-5/8"	5506	5552D	3"	5596	
1-3/4"	5507	5556D	3-1/8"	5600	
1"	5501				

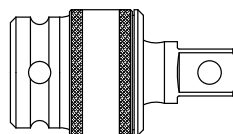

## 1" DRIVE INDIVIDUAL UNIVERSAL JOINT

MODEL	SIZE
5304	Universal Joint



## 1" DRIVE INDIVIDUAL RETAINING PIN & RING SETS

MODEL	SIZE
5301	1-11/16" Pin & Ring Set
5302	1-3/4" Pin & 1-7/8" Ring

## #5 SPLINE DRIVE METRIC INDIVIDUAL SOCKETS

SIZE	STANDARD	DEEP	SIZE	STANDARD	DEEP
METRIC	MODEL	MODEL	METRIC	MODEL	MODEL
22mm	5522M		33mm	5533M	5533MD
24mm	5524M		35mm	5535M	
25mm	5525M		36mm		5536MD
27mm	5527M		38mm	5538M	
29mm	5529M		40mm	5540M	
30mm	5530M		41mm	5541M	
32mm	5532M		46mm	5546M	

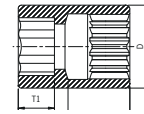

Standard

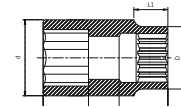

Deep

## #5 SPLINE DRIVE INDIVIDUAL SAE & METRIC SPECIALTY SOCKETS

SIZE	SQUARE	HEAVY DUTY SQUARE	THIN WALL	DEEP THIN WALL	EXTRA DEEP HEX
SAE	MODEL	MODEL	MODEL	MODEL	MODEL
13/16"	5532	5532HDS			
7/8"	5500S				
15/16"	5510				
1-1/16"			5527		
1-1/8"			5528		
1-1/4"			5529		
1-5/16"				5542DT	
1-1/2"				5548DT	5548XDH
1-1/2" x 13/16"	5530				
17mm	5517MSS				
21mm	5521MSS				
35mm				5535MDT	
41mm				5541MDT	

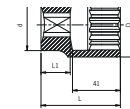

Square

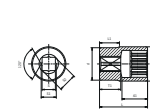

Heavy Duty Square

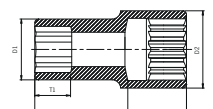

Thin Wall

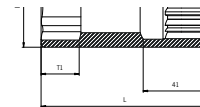

Deep Thin Wall

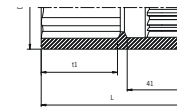

Extra Deep Hex



### SMALL BLOCK CHEVY, CHEVY V6 & 4 CYL. ENGINES CRANKSHAFT TURNING SOCKET

- Aluminum metal construction
- Fits 1.255 ID Crank Snout with 3/16" keyway

10000

WARNING: Use of this socket with an impact tool can cause serious injury.



### SMALL BLOCK FORD, BUICK & PONTIAC CRANKSHAFT TURNING SOCKET

- Aluminum metal construction
- Fits 1.385 ID Crank Snout with 3/16" & 1/4" keyways

10001

WARNING: Use of this socket with an impact tool can cause serious injury.



### CRANKSHAFT TURNING SOCKET BIG BLOCK CHEVY

- Aluminum metal construction
- Fits 1.610 ID Crank Snout with 3/16" keyway

10002

WARNING: Use of this socket with an impact tool can cause serious injury.



### 5.5MM FORD DISTRIBUTOR MODULE SOCKET

- Forged from Chrome-Vanadium alloy steel
- Designed for use on 7/32" hex retaining bolts on Ford distributor modules

10009

WARNING: Use of this socket with an impact tool can cause serious injury.



### UNIVERSAL OXYGEN SENSOR SOCKET

- Forged from Chrome-Vanadium alloy steel for maximum strength
- Works on all domestic and imported vehicles with oxygen sensors; slot in socket's side allows wire clearance — 7/8" hex, 3-7/8" socket length

10010

WARNING: Use of this socket with an impact tool can cause serious injury.

## DEEP OIL SWITCH SOCKET

- Remove and replace oil pressure sending units on 1987 to newer GM engines

10011

WARNING: Use of this socket with an impact tool can cause serious injury.



## 3-5/8" AXLE NUT SPANNER SOCKET

- Forged from Chrome-Vanadium alloy steel
- Six-lug, spanner-type wrench removes and installs rear wheel bearing locknuts; services 1954-current Chevrolet and GMC 15,000 lb. axles; 1966-current 17,000 lb. 2 speed axles; 1965-current 15,000 lb. trailing axles

10205

WARNING: Use of this socket with an impact tool can cause serious injury.



## 2-7/8" AXLE NUT SPANNER SOCKET

- Forged from Chrome-Vanadium alloy steel
- Six-lug, spanner-type wrench removes and installs rear wheel bearing locknuts; services 1954-current Chevrolet and GMC 11,000 to 13,500 lb. axles

10206

WARNING: Use of this socket with an impact tool can cause serious injury.



## 2-5/8" AXLE NUT SPANNER SOCKET

- Forged from Chrome-Vanadium alloy steel
- Six-lug, spanner-type socket removes and installs rear wheel bearing locknuts on 1946-present Chevrolet and GMC 5200 and 7200 lb axles

10207

WARNING: Use of this socket with an impact tool can cause serious injury.





### 1-59/64" BALL JOINT SOCKET

- Removes and installs the ball joints used on mid-size, rear-wheel drive Chrysler cars — fits 1-59/64" ball joints

10213

WARNING: Use of this socket with an impact tool can cause serious injury.



### 2-9/64" BALL JOINT SOCKET

- Removes and installs the ball joints used on Chrysler/Dodge light trucks and vans — fits 2-9/64" ball joints

10214

WARNING: Use of this socket with an impact tool can cause serious injury.



### 3/4" RATCHETING LOCKNUT TOOL FOR FORD TRUCKS

- Small end fits Ford 1986 to 1994 light trucks with Dana 44 front axle; large end fits 1985 and newer Ford F-150 and F-350 trucks with Dana full floating rear axle — this flip socket allows for dual application

10636

WARNING: Use of this socket with an impact tool can cause serious injury.



### TRANSIT LOCK NUT TOOL 1/2" SQUARE DRIVE

- Forged from Chrome-Vanadium alloy steel
- For Ford locknuts fitted on pre-1998 Ford Transit 80, 100, 115, and 120 models with type 34 axles

10209

WARNING: Use of this socket with an impact tool can cause serious injury.

## 4 LUG DRIVE PINION SHAFT FLANGE NUT SOCKET

- Forged from Chrome-Vanadium alloy steel
- Applicable for use on Mercedes Benz models 107, 114, 115, and 116 when removing the drive pinion shaft flange nut of the differential

10204

WARNING: Use of this socket with an impact tool can cause serious injury.



## FOUR WHEEL DRIVE SPINDLE NUT WRENCH

- Forged from Chrome-Vanadium alloy steel
- Services 1988-95 Isuzu Trooper, Rodeo, Amigo, and pickups; 1985-89 Honda Passport; Jeep J20 pickups with Dana 60 Axle

10202

WARNING: Use of this socket with an impact tool can cause serious injury.



## FOUR WHEEL DRIVE FRONT SPINDLE PULLER

- Forged from Chrome-Vanadium alloy steel
- For use when removing the front spindle on light duty 4WD trucks. Applicable to full size Ford, GM, International, and Jeep pick-ups with Dana front Axles; also applicable to Ford Ranger and Bronco II - fits spindle thread sizes 2"-16, 1-5/8"-16, 38mm-1.5

10208

WARNING: Use of this socket with an impact tool can cause serious injury.



## OXYGEN SENSOR SOCKET SET

- Easily removes vacuum switches, oil pressure sending units, brake light switches, and oxygen sensors on most car models

2850 SET OF 7

MODEL	SIZE
28501	29mm pressure/vacuum switch socket
28502	7/8" vacuum switch socket with 7.5mm gap
28503	27mm oil pressure sending unit socket
28504	7/8" vacuum switch socket with 20.6mm gap
28505	1-1/16" and 1" oil pressure sending unit socket
28506	7/8" short oxygen sensor socket
28507	7/8" hex, 1/2" double square driver





## SUPER REDUCER SET

2343

MODEL	SIZE	MODEL	SIZE
2303	1/2" F x 3/8" M	3303	3/8" F x 1/4" M
4305	3/4" F x 1/2" M		

SPEC.

## INDIVIDUAL EXTENSIONS

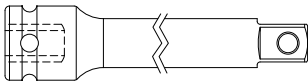

Square

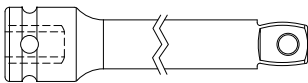

Wobble

SIZE	3/8"	1/2"	3/4"	1"	1/2" WOBBLE	3/8" WOBBLE	#5 SPLINE
SAE	Model	Model	Model	Model	Model	Model	Model
3"	3503	2503			2503W	3503W	
5"	3505	2505			2505W	3505W	
6"			4302	5300			
8"							5608
10"	3510	2510	4310	5310	2510W	3510W	
13"			4313	5313			
15"	3515	2515			2515W	3515W	5615
24"		2524					
36"		2536					
36" for Transmissions 1/2"(F) x 3/8"(M)		2536T					

## INDIVIDUAL ADAPTERS AND REDUCERS

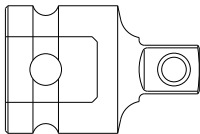

SIZE	ADAPTER MODEL	REDUCER MODEL	SIZE	ADAPTER MODEL	REDUCER MODEL
3/8"(F) x 1/4"(M)	1805	3303	3/4"(F) x 1"(M)	4300	
3/8"(F) x 1/2"(M)	3300		1"(F) x 3/4"(M) w/ ball ret.	5303	5305
1/4"(F) x 3/8"(M)	1801		1"(F) x 1-1/2"(M) w/ pin hole	5306	
1/2"(F) x 3/8"(M)	2301	2303	1-1/2"(F) x 1"(M) w/ pin hole	6332	
1/2"(F) x 3/4"(M)	2302		#5(F) x 3/4"(M) w/ ball ret.	5524	
3/4"(F) x 1/2"(M)	4301	4305	#5(F) x 1"(M) w/ pin hole	5531	